

**LOS ANGELES COUNTY
DEPARTMENT OF PUBLIC WORKS**

BENCHMARKS



NEWHALL QUAD

**2009 ADJUSTMENT
2009 BASELINE
NAVD 88 DATUM FOOT/METER**

PREFACE

The Department of Public Works level net is composed of more than 1,700 miles or 2720 kilometers of levels supporting in excess of 9,000 benchmarks. Previously when a major readjustment of the net was undertaken, to emphasize the complete break with previous elevations, the CY, CG, and CL, series benchmarks were re-labeled DY, DG, and DL, respectively. Beginning in 1993 the Baseline readjustment year will be indicated on Baseline BM's, as indicated below (*). Henceforth all BM numbers will be labeled as a Y, G, or L series that will no longer indicate the major adjustment year.

To facilitate the adjustment, indexing and distribution of the adjusted values of the net, the county territory was divided into 33 quads or areas. For the identification purposes each quad was given a name (i.e. "Rosemead", "La Mirada", and "Santa Fe"...etc). When benchmarks and elevations in the quad are used, the name of the bench and quad must be stated in the description, i.e.:

(*)	BASELINE	90.057	L&BR IN CTR OF CB RET @ NE COR	Y 9191
	(1990)	295.461	LA HABRA BLVD & VALLEY HOME AVE	

It is expected that this general adjustment will for the most part remain sound for 8 to 10 years. Updating constrained adjustments will continue in the future. When a quad is readjusted, new elevations will be published and the date of readjustment will be noted in the benchmark description. Two benchmarks with different adjustment dates will not normally agree with each other.

The basic accuracy of the net is reflected by an indicated field probable error of ± 0.017 feet per mile (4mm per kilometer) of leveling as determined from conditions of closure. However, many years of experience in vertical control in the greater Los Angeles basin and Antelope Valley indicates that because of varying degrees of subsidence and heaving, the true datum is recovered only by obtaining substantial agreement of a number of benchmarks.

The users of this network of benchmarks are invited to assist in its maintenance by notifying this department of cases of obliteration, apparent mistakes in descriptions or elevations, and the disturbance of benchmarks.

Datum: North American Vertical Datum of 1988 (NAVD88)

Note: NAVD 1988 minus approximately 2.3 feet (70 cm) equals NGVD 1929 Datum. For more accurate equations at individual benchmarks refer to previous publications.

Abbreviations used in Benchmark Descriptions

Abbreviations	Descriptions	Abbreviations	Descriptions
<i>ABUT</i>	Abutment	<i>LT</i>	Lead and Tack
<i>ALG</i>	Along	<i>LACE</i>	Los Angeles City Engineer
<i>ANG PT</i>	Angle Point	<i>LACS</i>	La County Engineer
<i>B/W</i>	Back of Walk	<i>LAFC</i>	La County Flood Control
<i>BCR</i>	Begin Curb Return	<i>L&BN</i>	Lead and Bench Nail
<i>BC</i>	Begin Curve	<i>L&BR</i>	Lead and Brad
<i>BLDG</i>	Building	<i>L&N</i>	Lead and Nail
<i>BM</i>	Benchmark	<i>L&SPK</i>	Lead and Spike
<i>BT SPK</i>	Boat or Bolt Spike	<i>L&T</i>	Lead and Tack
<i>BR CAP</i>	Brass Cap Monument	<i>MCR</i>	Middle Curb Return
<i>C B</i>	Catch Basin	<i>MKD</i>	Marked
<i>CTR</i>	Center	<i>MC</i>	Middle Curve
<i>C/L</i>	Centerline	<i>MON</i>	Monument
<i>C/L INT</i>	Centerline Intersection	<i>N/O</i>	North of
<i>C/L PROD</i>	Centerline Produced	<i>NR</i>	Near
<i>CONC</i>	Concrete	<i>OPP</i>	Opposite
<i>COR</i>	Corner	<i>PI</i>	Point of Intersection
<i>COE</i>	Corps of Engineers	<i>PK&W</i>	PK Nail and Washer
<i>CULV</i>	Culvert	<i>P/L</i>	Property Line
<i>CYN</i>	Canyon	<i>POST</i>	Point on Simi-Tangent
<i>CB</i>	Curb	<i>PP</i>	Power Pole
<i>CS MON</i>	Co. Eng. Monument	<i>PVMT</i>	Pavement
<i>CT SPK</i>	Cut Spike	<i>PROD</i>	Produced
<i>DPW</i>	Dept of Public Works	<i>RD</i>	Road
<i>DR</i>	Driveway	<i>RDBM</i>	Road Dept Benchmark
<i>E/O</i>	East of	<i>RDBM TAG</i>	Road Dept Benchmark Tag
<i>ECR</i>	End Curb Return	<i>RR</i>	Railroad
<i>EC</i>	End Curve	<i>R/W</i>	Right of Way
<i>ENT</i>	Entrance	<i>SDMH</i>	Storm Drain Manhole
<i>FL</i>	Flow line	<i>SMH</i>	Sewer Manhole
<i>FTG</i>	Footing	<i>SPK</i>	Spike
<i>FRWY</i>	Freeway	<i>ST&W</i>	Spike Tin and Washer
<i>F/W</i>	Front of Walk	<i>S/O</i>	South of
<i>GAR</i>	Garage	<i>TP</i>	Telephone Pole
<i>HDWL</i>	Head Wall	<i>USC&GS</i>	US Coast and Geodetic Survey
<i>HSE</i>	House	<i>USGS</i>	US Geological Survey
<i>HWY</i>	Highway	<i>WK</i>	Walk
<i>INT</i>	Intersection	<i>W/O</i>	West of
<i>IP</i>	Iron Pipe		

QUAD COVERAGE INDEX MAP



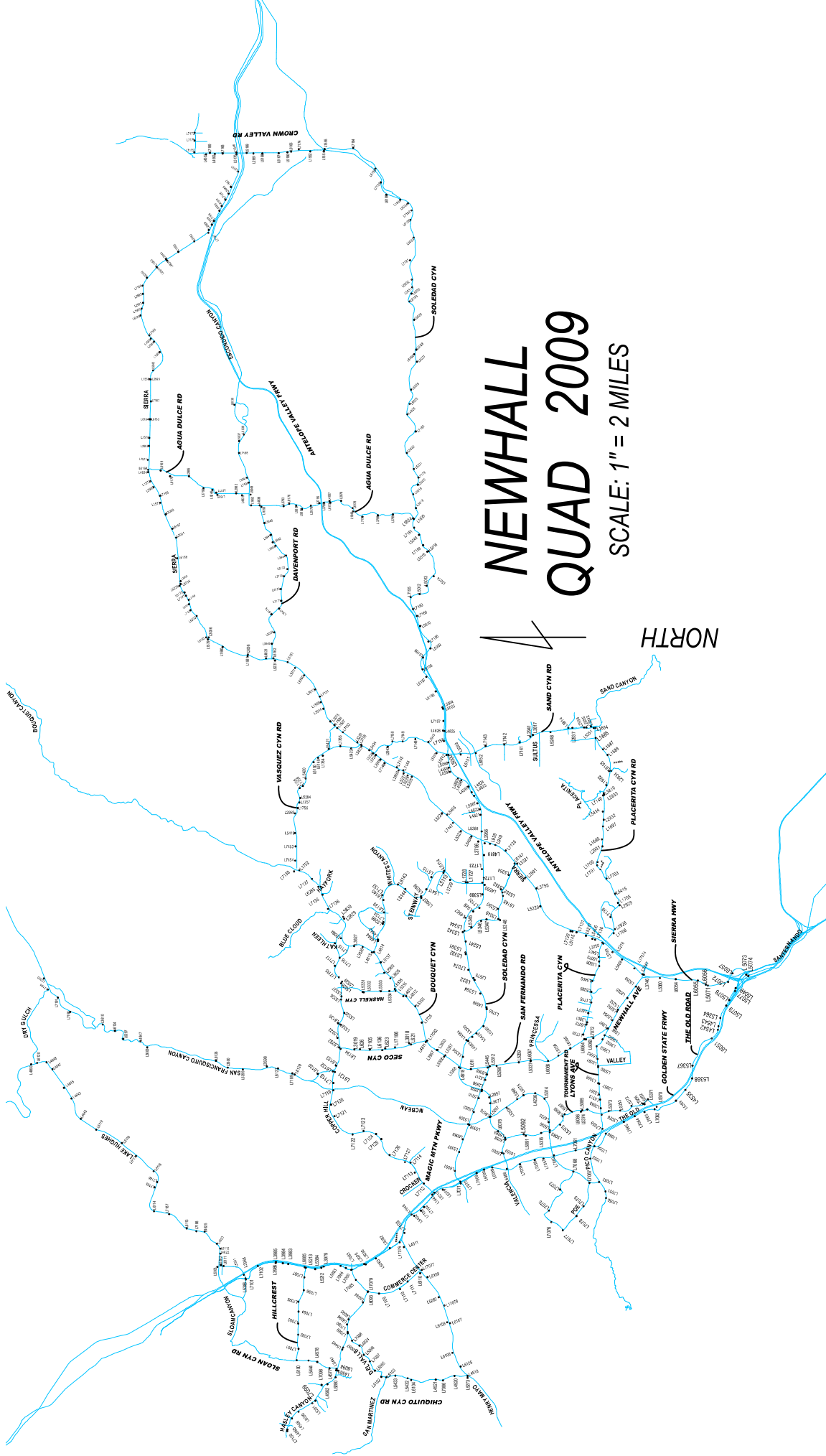

NEWHALL QUAD 2009

SCALE: 1" = 2 MILES

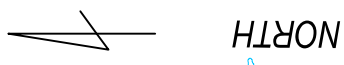

QUAD YEAR	ELEV FOOT/METER	DESCRIPTION	BM NUMBER
NEWHALL (2009)	1,287.201 392.340	RDBM TAG IN CB 1' E/O BCR OF ABANDON DRWY TO WILLIAM S HART PARK 55' S/O C/L NEWHALL AVE & 185' SW/O C/L 5TH ST	L 596
NEWHALL (2009)	1,283.301 391.151	L&BN IN N CB 4' E/O BCR @ NE COR SAN FERNANDO RD & 5TH ST	L 597
NEWHALL (2009)	1,157.800 352.899	USC&GS MON IN S END OF CONC HDWL 49' E/O C/L BOUQUET CYN RD & 70' S/O C/L PROD CINEMA DR MKD (X-898 1955)	L 611
NEWHALL (2009)	1,226.343 373.790	L&T IN S CB 1' E/O BCR @ SE COR SECO CYN RD & ARRIBA DR 66' E & 18' S/O C/L INT MKD (EV 3)	L 621
NEWHALL (2009)	1,258.622 383.629	L&T IN E CB (E SERV RD) SECO CYN RD 528' N/O DECORO DR & 18' N/O PI FRONT OF HSE #27204 MKD (RDBM)	L 623
NEWHALL (2009)	1,299.453 396.074	L&BN IN E CB 10' S/O BCR @ SE COR (E SERV RD) SECO CYN RD & CAVELLO DR 60' S & 15' E/O C/L MKD (BM EV 10)	L 626
NEWHALL (2009)	1,245.523 379.637	RDBM TAG IN W END OF N HDWL SPRR CULV #447.63 92' S/O C/L SOLEDAD CYN RD & 0.3MI E/O GOLDEN OAK RD	L 922
NEWHALL (2009)	1,342.941 409.330	RDBM TAG IN W END S HDWL MM3.71, 193' S/O C/L SOLEDAD CYN RD & 0.2MI E/O C/L LANGSIDE AVE	L 928
NEWHALL (2009)	1,432.737 436.700	RDBM TAG IN CB @ N END CTR ABUT OF BR #B1784 ON SIERRA HWY OVER SANTA CLARA RIVER 0.3MI S/O SOLEDAD CYN RD	L 939
NEWHALL (2009)	1,431.451 436.308	FC MON IN CB @ S END CTR ABUT OF BR #B1784 ON SIERRA HWY OVER SANTA CLARA RIVER 0.3MI S/O SOLEDAD CYN RD MKD (BM 97-10 1950)	L 940
BASELINE (2009)	2,967.550 904.512	CS MON FL @ NE COR SIERRA HWY & CROWN VALLEY RD 50' N & 30' E/O C/L INT MKD (R/W MON RE 2177) 8' SE/O PP #593220H	L 1546
BASELINE (2009)	2,705.150 824.532	L&BN IN CONC DRWY TO HSE #32109 CROWN VALLEY RD 33' W/O C/L & 39' N/O C/L GILLESPIE AVE TO W	L 1552
BASELINE (2009)	2,701.424 823.397	L&T IN S END CONC HDWL CULV 60' E C/L CROWN VALLEY RD & 20' SE/O C/L SOLEDAD CYN RD 39' E/O CE MON IN WELL @ MI MKR #23.29	L 1554
BASELINE (2009)	2,701.052 823.283	USC&GS MON 230' S/O C/L SOLEDAD CYN RD & 30' E/O C/L CROWN VALLEY RD MKD (H 53 1926) 2' S/O CONC UTILITY BOX	L 1555
NEWHALL (2009)	3,006.367 916.343	CSBM MON 43' N/O C/L SIERRA HWY & 0.65MI E/O C/L RED ROVER MINE RD 33' W/O PP #4261738E MKD (BM 201-74 1961 RE 5869)	L 1557
NEWHALL (2009)	3,043.781 927.747	CSBM MON IN E END HDWL CULV 25' N/O C/L SIERRA HWY & 0.40MI W/O RED ROVER MINE RD @ MI MKR #29.59 MKD (BM 201-75A 1961)	L 1559
NEWHALL (2009)	3,200.486 975.511	CSBM MON IN W END HDWL CULV 20' N/O C/L SIERRA HWY & 0.20MI E/O SHANNONDALE RD MKD (BM 201-77 1961) NR MI MKR #30.66	L 1562
NEWHALL (2009)	3,308.124 1,008.319	CSBM MON IN E END HDWL 25' N/O C/L SIERRA HWY & 43' W/O DRWY TO MT HOME RETREAT 0.30MI W/O SHANNONDALE RD MKD (BM 201-78 RE 5869) @ MI MKR #31.24	L 1563

QUAD YEAR	ELEV FOOT/METER	DESCRIPTION	BM NUMBER
NEWHALL (2009)	3,239.856 987.511	CSBM MON 80' N/O C/L SIERRA HWY & 520' E/O C/L THOMAS RD & 26' E/O PP #4261701E 168' W/O MI MKR # 32.28 MKD (BM 201-80 1961 RE5869) 2" IP 2' S/O MON	L 1565
NEWHALL (2009)	3,080.292 938.876	CSBM MON 50' N/O C/L SIERRA HWY & 95' E/O C/L ROBINSONG RD (PVT) TO THE S MKD (BM 201-81 1961) 2" IP MKR 2' N/O MON	L 1566
NEWHALL (2009)	2,985.169 909.882	CSBM MON 50' N/O C/L SIERRA HWY & 164' E/O C/L VALLEJO VISTA DR (PVT) 150' NE/O PP #2330761E MKD (BM 201-82 1961 RE 5869) 2" IP 2'M S/O MON	L 1567
NEWHALL (2009)	2,825.993 861.365	CSBM MON IN W END HDWL CULV 20' N/O C/L SIERRA HWY & 325' E/O C/L DRWY TO LACO FIRE STA #81 MKD (BM 201-83 1961 RE 5869) @ MI MKR #34.10	L 1568
NEWHALL (2009)	2,771.610 844.789	CSBM MON 53' N/O C/L SIERRA HWY & 95' E/O C/L DIRT DRWY TO HSE #9807 66' E/O PP #276392E MKD (BM 201-85 1961 RE 5869) 2" IP 2' S/O MON 315' W/O C/L INT PEPPERTREE LN (PVT)	L 1570
NEWHALL (2009)	2,733.833 833.275	CSBM MON 56' N & 45' E/O C/L INT SIERRA HWY & JOHNSON RD MKD (BM 201-86 1961 RE 5869) 2" MRK PIPE 2' S/O MON	L 1571
NEWHALL (2009)	2,735.912 833.908	CSBM MON 45' N/O C/L SIERRA HWY & 59' E/O PP #4277517E (3' E/O GUY POLE) MKD (BM 201-87 1961 RE 5869) 0.3MI W/O AQUA DULCE CYN RD 167' E/O MI MRK 36.21	L 1572
NEWHALL (2009)	2,673.798 814.976	CSBM MON 56' N C/L SIERRA HWY & 79' E/O ELY MOST DRWY TO HSE #11253 7' E/O PP #1029748E MKD (BM 201-88 1961 RE 5869) NGS MKR 1' N/O MON	L 1573
NEWHALL (2009)	2,259.335 688.647	CSBM MON IN W END NLY HDWL CULV 55' S C/L SIERRA HWY & 15' W/O C/L PI PROD CENTER ST 153' W/O C/L DRWY BLDG #13136 MKD (BM 201-92 1961) NR MI MKR #38.78	L 1577
NEWHALL (2009)	2,089.799 636.973	CSBM MON 56' W/O C/L SIERRA HWY & 20' N/O C/L PI PROD OF ENT TO ROWHER FLAT 112' N/O PP #1848239E 151' S/O PP #1848238E MKD (BM 201-94 1961) 2" IP 2' W/O MON	L 1579
NEWHALL (2009)	2,021.823 616.254	CSBM MON IN W END WINGWALL OF CULV 33' W/O C/L SIERRA HWY & 0.55MI N/O DAVENPORT RD MKD (BM 201-96 1961) @ MI MRK 40.74	L 1581
NEWHALL (2009)	1,832.104 558.427	CSBM MON 30' W/O C/L SIERRA HWY & 1.2MI N/O VASQUEZ CYN RD 5' S/O PP #461357E OPP THE OLD DIRT RD PVT MKD (BM 201-100 1961) 1' S/O SURVEY MKR	L 1585
NEWHALL (2009)	1,787.610 544.865	CSBM MON IN N END HDWL CULV 20' W/O C/L SIERRA HWY & 0.8MI N/O VASQUEZ CYN RD MKD (BM 201-101 1961 RE 5869) @ MI MRK 43.52	L 1586
NEWHALL (2009)	1,761.451 536.892	CSBM MON IN S END HDWL CULV 20' W/O C/L SIERRA HWY & 0.5MI N/O VASQUEZ CYN RD NR MI MKR #43.57 MKD (BM 201-102 1961)	L 1587
NEWHALL (2009)	2,526.596 770.109	USC&GS MON IN W END N WINGWALL OF W HDWL SPRR CULV 72' E/O C/L SOLEDAD CYN RD & 600' S/O C/L CROWN VALLEY RD MKD (Y 486 1955) NR MI MKR #21.05	L 1600
NEWHALL (2009)	1,968.326 599.948	RDBM MON IN WELL 48' E C/L AGUA DULCE CYN RD & 225' N/O C/L SOLEDAD CYN RD 2" IP 2' E/O MON	L 1634

QUAD YEAR	ELEV FOOT/METER	DESCRIPTION	BM NUMBER
NEWHALL (2009)	1,961.121 597.751	CS MON IN NW BRIDGE ABUT #B790 OVER SPRR 10' N C/L SOLEDAD CYN RD & 190' E/O C/L AGUA DULCE CYN RD MKD (1958.104 RE 2177)	L 1635
NEWHALL (2009)	2,061.876 628.462	L&BN IN SWLY BRIDGE ABUT #1023 13' WLY/O C/L AGUA DULCE CYN RD & 130' N/O C/L DIRT DRWY N/O N P/L HSE#30925 & 25' N/O GUY POLE #1028088H MKD (BM)	L 1640
NEWHALL (2009)	2,481.955 756.502	CS MON 0.25' UP @ SW COR AGUA DULCE CYN RD & DAVENPORT RD 25' S & 28'M W/O C/L INT MKD (BM NC 1049 RE 329) 5' N/O PP#1829388E	L 1650
NEWHALL (2009)	2,490.417 759.081	RDBM TAG IN CTR OF ROCK HDWL CULV 20' S/O C/L AQUA DULCE CYN RD & 100' E/O DRWY TO HSE #32901 @ MI MKR #2.10	L 1652
NEWHALL (2009)	2,534.194 772.425	CS MON FL IN SE COR OF PORCH @ BLDG #33355 AGUA DULCE CYN RD 35' W/O C/L & 120' S/O C/L DARLING RD MKD	L 1655
NEWHALL (2009)	1,847.363 563.078	FC MON IN W WINGWALL @ SW COR BRIDGE 26' S/O C/L PLACERITA CYN RD & 400' W/O C/L SAND CYN RD MKD (BM 146-03390 1963)	L 1684
NEWHALL (2009)	1,834.898 559.279	L&BN IN ROCK WALL OF DRAIN ON SE COR PLACERITA CYN RD & RAVENHILL RD 18' S & 52' E/O C/L INT MKD (1830.69)	L 1685
NEWHALL (2009)	1,885.420 574.678	L&T IN CTR CONC HDWL 18' S C/L PLACERITA CYN RD & 87' E/O C/L PACY ST 56' SE/O PP #955E (10' E/O MI MKR #6.67)	L 1687
NEWHALL (2009)	1,912.052 582.795	L&BN IN E ROCK WALL OF DRAIN 20' S C/L PLACERITA CYN RD & 0.4MI W/O RAVENHILL RD 60' SE/O PP #2265534 NR MM POST #6.59	L 1688
NEWHALL (2009)	1,913.632 583.277	L&BN ROCK WALL OF DRAIN 15' N/O C/L PLACERITA CYN RD&1.0MI W/O RAVENHILL RD, 7' E/O 55" OAK,MKD (BM)	L 1692
NEWHALL (2009)	1,802.818 549.501	L&BN IN ROCK WALL 20' S/O C/L PLACERITA CYN RD & 0.9MI E/O RUNNING HORSE RD 6' W/O PP (NO #) MKD (BM) 150' W/O MM #4.97	L 1697
NEWHALL (2009)	1,756.550 535.398	L&BN IN ROCK WALL 16' N/O C/L PLACERITA CYN RD & 0.6MI E/O RUNNING HORSE RD 56' W/O PP (NO #) 10' S/O MM #4.64	L 1698
NEWHALL (2009)	1,660.531 506.131	L&BN IN ROCK WALL OF DRAIN 25' S C/L PLACERITA CYN RD & 175'E/O RUNNING HORSE RD 0.5MI E/O ENT TO PLACERITA STATE PARK 105' W/O PP (NO #) MKD (BM) @ MM #4.14	L 1700
NEWHALL (2009)	1,630.074 496.848	L&BN IN ROCK WALL OF DRAIN 25' S C/L PLACERITA CYN RD & 0.1MI W/O RUNNING HORSE RD 20' E/O PP (NO #) MKD (BM 129-02460) @ MM #4.00	L 1701
NEWHALL (2009)	1,526.858 465.388	L&BN IN CONC HDWL @ SE COR BRIDGE 30' S/O C/L PLACERITA CYN RD & 305' W/O ENT TO PLACERITA ST PARK MKD (BM) @ MM #3.64	L 1703
NEWHALL (2009)	1,576.626 480.557	L&BN IN ROCK WALL OF CULV 18' N C/L PLACERITA CYN RD & 5' E/O SIERRA HWY 130' NE/O PP #1382961E MKD (BM)	L 1705
NEWHALL (2009)	1,466.168 446.889	L&BN IN ROCK HDWL CULV @ MM #2.45 25' S/O C/L PLACERITA CYN RD & 0.35MI E/O SIERRA HWY MKD (BM)	L 1708
NEWHALL (2009)	1,302.848 397.109	L&T IN NW COR TOP CONC STEP OF WALK @ SE COR PLACERITA CYN RD & QUIGLEY CYN RD	L 1716

QUAD YEAR	ELEV FOOT/METER	DESCRIPTION	BM NUMBER
NEWHALL (2009)	1,258.102 383.471	CS MON IN WELL 2' DN @ C/L INT PLACERITA CYN RD & 12TH ST	L 1720
NEWHALL (2009)	1,380.281 420.711	RDBM TAG IN W CB 3' N/O BCR @ NW COR SOLEDAD CYN RD & CROSSGLADE AVE	L 1723
NEWHALL (2009)	1,369.086 417.299	RDBM TAG IN E CB 39' N/O BCR @ NE COR SOLEDAD CYN RD & WHITES CYN RD	L 1724
NEWHALL (2009)	1,348.517 411.029	LS TAG #2602 IN E CB 3' S/O BCR @ SE COR WHITES CYN RD & PLEASANTDALE ST	L 1727
NEWHALL (2009)	1,347.402 410.689	LS TAG #2602 IN E CB 5' N/O BCR @ NE COR WHITES CYN RD & PLEASANTDALE ST	L 1728
NEWHALL (2009)	1,359.957 414.516	LS TAG #2602 IN W CB 5' S/O BCR, SW COR WHITES CYN RD & RANIER ST	L 1729
NEWHALL (2009)	1,227.122 374.028	RDBM TAG IN WLY CB 1' N/O BCR, SW COR ALAMOGORDO RD & BOUQUET CYN RD	L 1735
NEWHALL (2009)	1,515.269 461.855	RDBM TAG IN CTR HDWL CULV 25' E/O C/L BOUQUET CYN RD & 214' S/O C/L VASQUEZ CYN RD @ MI MKR POST #18.04	L 1752
NEWHALL (2009)	1,660.392 506.089	L&T IN W ROCK WALL OF DRAIN 16' N C/L VASQUEZ CYN RD & 0.35MI E/O LOST CREEK RD 43' W/O PP #1527345E 131' E/O MI MKR #0.96 MKD (BM)	L 1756
NEWHALL (2009)	1,684.379 513.400	RDBM TAG IN ROCK WALL OF DRAIN 15' S/O C/L VASQUEZ CYN RD & 0.5MI E/O LOST CREEK RD 90' SW/O PP #4761516E, @ MI MRK #1.12	L 1757
NEWHALL (2009)	1,898.196 578.572	L&T IN W ROCK WALL OF DRAIN 30' SE C/L VASQUEZ CYN RD NR BC 1.1MI E/O LOST CREEK RD 28' S/O PP #4761520E MKD (RDBM)	L 1758
NEWHALL (2009)	1,900.075 579.145	L&T IN E ROCK WALL OF DRAIN 20' SE C/L VASQUEZ CYN RD & 1.1MI E/O LOST CREEK CYN RD 18' S/O PP #4761520E MKD (RDBM)	L 1759
NEWHALL (2009)	1,819.179 554.487	L&T IN N ROCK WALL OF DRAIN 105' W/O PP (#1534653E) 29' S/O C/L VASQUEZ CYN RD & 56' W/O C/L BURTON WAY (PVT) NR MI MKR #2.66 MKD (RDBM)	L 1764
NEWHALL (2009)	1,748.279 532.877	L&BN IN NE COR BRIDGE #3388 16' E/O C/L VASQUEZ CYN RD & 269' N/O C/L MEADSTONE RD (PVT) 56' NE/O PP #1534844E NR MI MRK #3.15	L 1765
NEWHALL (2009)	1,059.359 322.894	RDBM TAG IN CTR S END N MEDIAN OF THE OLD RD 32' N/O C/L RYE CANYON RD	L 1947
NEWHALL (2009)	1,034.287 315.252	L&BN IN N END CONC HDWL 30' E/O C/L THE OLD RD (E ROADWAY) & 0.6MI S/O HENRY MAYO DR NR MI MKR POST #6.25	L 1948
BASELINE (2009)	2,888.965 880.559	CSBM MON @ SW COR CROWN VALLEY RD & CEDRAL ST 70' S & 50'M W/O C/L INT MKD (NC 1008 1963 RE 5869) 3' W/O CH LINK FENCE	L 2851
NEWHALL (2009)	1,449.922 441.938	RDBM TAG IN S CB, SW COR WHISPERING LEAVES DR & SIERRA HWY, 1' W BCR	L 2891
NEWHALL (2009)	1,152.386 351.248	RDBM TAG IN W CB VALENCIA BLVD 7' S/O BCR @ SW COR MAGIC MT PKWY & VALENCIA BLVD 97' S & 43'M W/O C/L INT	L 2895

QUAD YEAR	ELEV FOOT/METER	DESCRIPTION	BM NUMBER
NEWHALL (2009)	1,153.020 351.442	RDBM TAG IN E CB VALENCIA BLVD 3' S/O BCR @ SE COR MAGIC MT PKWY & VALENCIA BLVD 102' S & 43' E/O C/L INT	L 2896
NEWHALL (2009)	1,324.113 403.591	CS MON 2" UP 49' SLY/O C/L NEWHALL AVE & 125' WLY/O C/L PROD VALLE DEL ORO 8' S/O CF MKD (BM NE-1)	L 2925
NEWHALL (2009)	1,471.268 448.444	CS MON 0.5' UP 25' S/O C/L PLACERITA CYN RD & 0.4MI E/O SIERRA HWY 3' S/O PP #1382950E & 131' W/O MM #2.57 MKD (BM 203-17 1966)	L 2928
NEWHALL (2009)	1,579.766 481.514	CS MON 0.5' UP 30' S/O C/L PLACERITA CYN RD & 1.0MI E/O SIERRA HWY 3' S/O PP #1382961E MKD (BM 203-16 1966)	L 2929
NEWHALL (2009)	1,773.699 540.625	CS MON 0.7' UP 30' S/O C/L PLACERITA CYN RD & 0.4MI E/O RUNNING HORSE RD 138' W/O PP #2329990E MKD (BM 203-13 1966) MRK POST 2' W/O MON	L 2931
NEWHALL (2009)	1,866.894 569.031	CS MON 0.5' UP 25' S/O C/L PLACERITA CYN RD & 1.0MI E/O RUNNING HORSE RD 5' E/O PP (NO #) 6' SWLY/O MM #5.05 MKD (BM 203-12 1966) MRK POST 2' N/O MON	L 2932
NEWHALL (2009)	1,869.709 569.889	CS MON FL 79' S/O C/L PLACERITA CYN RD & 140' W/O DIRT RD (TO THE S) 3' E/O 36" OAK, 1.25MI W/O RAVENHILL RD MKD (203-11 RE329)	L 2933
NEWHALL (2009)	1,975.174 602.035	CS MON 0.5' UP 25' S/O C/L PLACERITA CYN RD & 105' W/O RD TO SPECIAL DEVICES INC 0.9MI W/O RAVENHILL RD 135' W/O MM 6.16 MRK POST 2' W/O MON MKD (BM 203-10 1966 RE 5869) ALSO MKD (USGS PB 0111 1976)	L 2934
NEWHALL (2009)	1,821.228 555.112	LS TAG #2698 IN E CB 6' S/O BCR @ SE COR SAND CYN RD & SILVER STAR LN	L 2935
NEWHALL (2009)	1,817.599 554.006	LS TAG #2698 IN E CB 10' N/O BCR @ NE COR SILVER STAR LN & SAND CYN RD	L 2936
NEWHALL (2009)	1,764.383 537.786	RDBM TAG IN E CB 2' S/O BCR @ SE COR SAND CYN RD & WARM SPRINGS DR	L 2937
NEWHALL (2009)	1,680.349 512.172	CS MON IN SW COR C B 1' N/O CF 18' N/O C/L CONDOR RIDGE RD & 141' E/O C/L SAND CYN RD MKD (BM 203-5 1966)	L 2941
NEWHALL (2009)	1,684.478 513.430	CS TAG IN ROCK HDWL CULV 20' E/O C/L SAND CYN RD & 0.5MI N/O SOLEDAD CYN RD 50' S/O PP #1123589E NR MI MKR POST #1.29	L 2945
NEWHALL (2009)	1,912.388 582.898	RDBM TAG IN NE COR ROCK HDWL CULV 20' W C/L SAND CYN RD & 0.45MI S SIERRA HWY (34' S/O PP #1072602E) S SIDE DR HSE #29627	L 2947
NEWHALL (2009)	1,671.658 509.523	FC MON IN N END CONC HDWL CULV #44.62 52' W/O C/L SIERRA HWY & 800' S/O SAND CYN RD 25' N/O HSE #16529 SIERRA HWY MKD (BM 145-01590 1963)	L 2949
NEWHALL (2009)	1,631.576 497.306	L&T IN N END CONC APRON (OLD) GAS STA @ 16869 SIERRA HWY 50' W/O C/L & 0.3MI S/O FITCH AVE MKD (RDBM) 7' S/O NLY P/L	L 2950
NEWHALL (2009)	1,438.917 438.583	RDBM TAG IN W CB SIERRA HWY 30' W/O W RDWY 85' S/O BCR & 165' S/O C/L SOLEDAD CYN RD	L 2956
NEWHALL (2009)	1,647.309 502.101	CS MON FL 100' N C/L VASQUEZ CYN RD & 0.25MI E/O LOST CREEK RD 80' N/O PP #1527343E MKD (BM V-8) MKR POST 3' UP 3' NE/O MON	L 2958

QUAD YEAR	ELEV FOOT/METER	DESCRIPTION	BM NUMBER
NEWHALL (2009)	1,304.237 397.533	RDBM TAG IN N CB URBAN DALE AVE 2' E/O BCR 20' N/O C/L & 72' W/O C/L BOUQUET CYN RD	L 2963
NEWHALL (2009)	1,183.054 360.596	RDBM TAG IN E CB BOUQUET CYN RD 44'M E/O C/L 3' N/O BCR & 62' N/O C/L ESPUELLA DR	L 2967
NEWHALL (2009)	1,245.738 379.702	RDBM TAG IN W END S HDWL SPRR CULV #447.63 112' S/O C/L SOLEDAD CYN RD & 0.3MI E/O GOLDEN OAK RD	L 2975
NEWHALL (2009)	2,123.314 647.188	CS MON FL 54' E/O C/L AGUA DULCE CYN RD & 74' N/O MI MKR #4.25 30' E/O PP#724369E MKD (B 1054 RE 5869) 2"IP IP 2' N/O MON	L 2978
NEWHALL (2009)	2,190.987 667.815	CS MON 36' W C/L AGUA DULCE CYN RD & 0.4MI N/O C/L (14 FRWY) MKD (BM NC 1052 RE 5869) 2" IP 2' N/O MON	L 2979
NEWHALL (2009)	2,513.169 766.016	CS MON 28' N/O C/L AGUA DULCE CYN RD & 100' E/O PI 0.27MI N/O DAVENPORT RD MKD (BM NC 1048 RE 5869) 2" IP 2' E/O MON	L 2981
NEWHALL (2009)	2,502.800 762.856	CS MON 28' W C/L AGUA DULCE CYN RD & 3' N/O N P/L HSE #33121 2' E/O PP #1988319E MKD (BM NC 1047) 2" IP 2' N/O MON	L 2982
NEWHALL (2009)	2,598.560 792.043	CS MON FL 35' W/O C/L AGUA DULCE CYN RD & 35' S/O WHITE FOX LN MKD (BM NC 1043 RE 5869) 15' S/O & 0.2' W/O SE COR FENCED PROP @ #34125	L 2985
NEWHALL (2009)	3,078.812 938.425	RDBM TAG IN W CB 10' S/O BCR 25' W/O C/L OFF-RAMP ANTELOPE VALLEY FRWY S BOUND @ RED ROVER MINE RD EXIT & 35' S/O C/L SIERRA HWY (0.10MI E/O WARD RD)	L 2989
NEWHALL (2009)	3,306.718 1,007.891	RDBM TAG IN W END HDWL CULV 25' S/O C/L SIERRA HWY & 50' W/O DRWY TO #6221 CHRISTIAN RETREAT 0.3MI W/O SHANNONDALE RD @ MI MKR #31.24	L 2991
NEWHALL (2009)	3,347.700 1,020.382	RDBM TAG W END HDWL 26' N C/L SIERRA HWY & 82' E/O C/L DUSTY DR (DIRT PVT) TO SO 16' W/O C/L SIERRA SUMMIT (PVT) TO NO @ MI MKR 31.89	L 2992
NEWHALL (2009)	3,239.795 987.492	RDBM TAG IN W END HDWL 30' N/O C/L SIERRA HWY & 690' ELY OF THOMAS RD 80' W/O PP #4261702E @ MI MKR #32.28	L 2993
NEWHALL (2009)	3,037.659 925.881	RDBM TAG IN E END HDWL 20' N/O C/L SIERRA HWY & 60' E/O C/L DRWY TO HSE #7720 @ MI MKR 33.01	L 2994
NEWHALL (2009)	2,823.795 860.695	LACO DPW TAG IN E END HDWL CULV 25' S/O C/L SIERRA HWY & 312' E/O C/L DRIVE LA CO FIRE STATION #81 #8710 W SIERRA HWY @ MI MKR #34.10	L 2996
NEWHALL (2009)	2,755.771 839.962	RDBM TAG IN E END OF HDWL 20' N/O C/L SIERRA HWY & 45' W/O C/L DRWY (DIRT) TO HSE #9905 @ MI MKR #35.33	L 2998
NEWHALL (2009)	2,732.630 832.908	RDBM TAG IN E END HDWL CULV 31' N/O C/L SIERRA HWY & 20' E/O C/L DRWY TO HSE #108350 (N SIDE) @ MKR #36.25 (0.35MI W/O AQUA DULCE CYN RD)	L 2999
NEWHALL (2009)	2,558.996 779.984	RDBM TAG IN E END HDWL CULV 20' S/O C/L SIERRA HWY & 1.1MI W/O AGUA DULCE CYN RD @ MI MKR 37.02	L 3000

QUAD YEAR	ELEV FOOT/METER	DESCRIPTION	BM NUMBER
NEWHALL (2009)	2,446.663 745.745	RDBM TAG IN E END HDWL CULV 23' S C/L SIERRA HWY & 350' W/O C/L MINT CYN RD NR MI MKR #37.44 (85' W/O ROZICH RD PVT)	L 3001
NEWHALL (2009)	2,369.438 722.207	RDBM TAG IN E END OF HDWL CULV 23' S C/L SIERRA HWY & 269' W/O C/L SIERRA VALLEJO RD (PVT) @ MI MKR #38.13	L 3003
NEWHALL (2009)	2,094.731 638.476	RDBM TAG IN S END HDWL CULV 25' W C/L SIERRA HWY & 1.4MI N/O DAVENPORT RD 240' N/O W ENT TO ROWHER FLAT @ MI MKR #39.96	L 3006
NEWHALL (2009)	2,021.091 616.030	L&N IN S END HDWL OF CULV 33' E/O C/L SIERRA HWY & 0.55MI N/O DAVENPORT RD @ MI MRK 40.74	L 3008
NEWHALL (2009)	1,922.566 586.000	FC MON IN N END HDWL 30' W C/L SIERRA HWY & 2.2MI N/O VASQUEZ CYN RD 0.5MI S/O DAVENPORT RD MKD (BM 145-03100 1964) @ MI MKR #41.87	L 3011
NEWHALL (2009)	1,881.982 573.630	FC MON IN S END HDWL CULV 25' W C/L SIERRA HWY & 1.7MI N/O VASQUEZ CYN RD 450' N/O BLDG #15401 MKD (BM 145-02690 1964) @ MI MKR #42.38	L 3013
NEWHALL (2009)	1,813.591 552.784	FC MON IN W END HDWL 20' N C/L SIERRA HWY & 1MI N/O VASQUEZ CYN RD @ MI MRK 42.62 MKD (BM 145-02390 1964)	L 3014
NEWHALL (2009)	1,788.050 544.999	RDBM TAG IN N END HDWL CULV 20' E/O C/L SIERRA HWY & 0.8MI N/O VASQUEZ CYN RD @ MI MRK 43.52	L 3015
NEWHALL (2009)	1,223.947 373.060	FC MON IN E CB 10' S/O BCR @ SE COR SECO CYN RD & ARRIBA DR MKD (BM 144-20150 1964)	L 3018
NEWHALL (2009)	1,317.290 401.511	FC MON IN W CB OF (E SERV RD) SECO CYN RD 15' W/O C/L & 46' S/O N END CUL-DE SAC IN FRT HSE #27656 (528' N CALVELLO DR) MKD (144-20770 1964)	L 3019
NEWHALL (2009)	1,265.354 385.681	RDBM TAG IN S CB 26' W/O BCR @ SW COR LYONS AVE & WILEY CYN RD 100' W & 40' S/O C/L INT (NR W END C B)	L 3026
NEWHALL (2009)	1,040.410 317.118	USC&GS MON IN SW COR BRIDGE 23' W/O C/L 'THE OLD ROAD' AND 530' S/O C/L LIVE OAK RD MKD (M 52 1926 RESET 1967)	L 3030
NEWHALL (2009)	1,293.664 394.310	RDBM TAG IN SE COR ROCK HDWL @ ANGLE PT 17' E/O C/L SAN FRANCISQUITO CYN RD & 0.45MI N/O SHAWNEE CT (TO THE E) @ MI MKR #17.56	L 3598
NEWHALL (2009)	1,327.897 404.744	RD MON IN WELL 0.7' DN 470' N C/L DIRT DRWY ENT TO #29874 SAN FRANCISQUITO CYN RD & 50' E/O C/L MKD (RD DEPT 1962) 2" IP 2' E/O MON	L 3600
NEWHALL (2009)	1,423.329 433.832	RDBM TAG IN LRG BOULDER 0.17MI N/O MI MKR #15.35 & 27' W/O C/L SAN FRANCISQUITO CYN RD 85' N/O MI MKR #15.19 (2" IP MKR 3' S/O MON)	L 3606
NEWHALL (2009)	1,577.067 480.691	FLAT HD SPK IN CONC WALL OPP POWER HSE #2 32300 SAN FRANCISQUITO CYN RD 25' W/O C/L @ STEEL LADDER INTO CHECK DAM BASIN	L 3610
NEWHALL (2009)	1,388.490 423.213	RDBM TAG IN E CB 2' S/O BCR @ SE COR SIERRA HWY & NEWHALL AVE	L 3746

QUAD YEAR	ELEV FOOT/METER	DESCRIPTION	BM NUMBER
NEWHALL (2009)	1,389.472 423.512	RDBM TAG IN N CB 2' E/O BCR @ NE COR SIERRA HWY & NEWHALL AVE	L 3747
NEWHALL (2009)	1,443.936 440.113	RDBM TAG IN W CB 15' S/O BCR @ SW COR SIERRA HWY & PLACERITA CYN RD	L 3749
NEWHALL (2009)	1,437.804 438.244	RDBM TAG IN N CB 2' W/O BCR @ NW COR SIERRA HWY & PLACERITA CYN RD	L 3750
NEWHALL (2009)	1,525.079 464.845	RDBM TAG IN N CB, NW COR FRIENDLY VALLEY PKWY & SIERRA HWY, 1' W/O BCR	L 3755
NEWHALL (2009)	1,442.500 439.675	CSBM MON IN WALK NW COR SOLEDAD CYN RD & SIERRA HWY 82' N & 49' W/O C/L MKD (BM 201-110 1968)	L 3756
NEWHALL (2009)	1,722.315 524.963	L&T IN N END HDWL OF CULV 33' E/O C/L SIERRA HWY & 236' N/O VASQUEZ CYN RD NR MI MKR #44.03	L 3758
NEWHALL (2009)	1,221.847 372.420	CSBM MON IN W END SPRR CULV (#448.29) 95'S/O C/L SOLEDAD CYN RD & 0.4MI W/O GOLDEN OAK RD MKD (BM 201-119A 1971 RE 5869)	L 3765
NEWHALL (2009)	2,579.335 786.184	CSBM MON 43' W/O C/L AGUA DULCE CYN RD & 151' S/O C/L DIRT DRWY TO HSE #33863 6' W/O BARBED WIRE FENCE MKD (BM NC 1044 RE 5869) 2" IP 2' N/O MON & 43' N/O PP#676356E	L 3792
NEWHALL (2009)	2,354.335 717.603	L&BN IN ROCK RET WALL 23' S C/L HDWL @ S END CULV 18' E/O C/L AGUA DULCE CYN RD & 48' S/O C/L CAMINO DEL SOL (PVT) TO THE W MKD (BM) NR MI MKR #2.93	L 3793
NEWHALL (2009)	2,210.339 673.713	ST HWY MON IN WELL 0.7' DN @ C/L AGUA DULCE CYN RD & 6' S/O C/L N SIDE ON-OFF RAMP (14) FRWY	L 3795
NEWHALL (2009)	2,207.390 672.815	ST HWY MON IN WELL 0.7' DN @ C/L AGUA DULCE CYN RD & 8' N/O C/L S SIDE ON-OFF RAMP (14) FRWY	L 3796
NEWHALL (2009)	2,049.826 624.789	RDBM TAG IN N WING WALL OF CULV 23' W/O C/L AGUA DULCE CYN RD & 0.9MI N/O SOLEDAD CYN RD @ MI MKR #5.23	L 3798
NEWHALL (2009)	2,001.184 609.963	L&BN IN ROCK HDWL 18' W C/L AQUA DULCE CYN RD & 0.55MI N/O SOLEDAD CYN RD 60' SW/O PP #2161900E MKD (BM) @ MI MKR #5.57	L 3799
NEWHALL (2009)	1,279.149 389.886	CSBM MON @ SE COR PLACERITA CYN RD & ADEN WAY 56' E & 20' S/O C/L INT 3' E/O PP #563622E MKD (BM 203-24A)	L 3801
NEWHALL (2009)	1,357.192 413.673	CSBM MON 60' S & 30' W/O C/L INT PLACERITA CYN RD & DIRT RD OPP DR TO HSE #21005 5' SELY PP#794925E MKD (BM 203-21A)	L 3806
NEWHALL (2009)	1,877.714 572.329	L&T IN E END HDWL 20' S & 40' W/O C/L INT PLACERITA CYN RD & DIRT RD (TO THE S) 1.25MI W/O RAVENHILL RD @ MM #5.69	L 3810
NEWHALL (2009)	1,843.223 561.816	L&BN IN E CB 3' S/O BCR @ NE COR SAND CYN RD & BEAVER RUN RD 53' N & 30' E/O C/L INT MKD BM	L 3812
NEWHALL (2009)	1,778.339 542.039	CS MON 0.3' UP 45' E/O C/L SAND CYN RD & 528' N/O RUTH SPRINGS DR 5' S/O PP #X7231E MKD (BM 203-7A 1971)	L 3814
NEWHALL (2009)	1,680.287 512.153	L&BN IN W END C B 18' S/O C/L CONDOR RIDGE RD & 141' E/O C/L SAND CYN RD MKD (BM)	L 3817

QUAD YEAR	ELEV FOOT/METER	DESCRIPTION	BM NUMBER
NEWHALL (2009)	1,182.954 360.565	CSBM MON FLUSH 1' N/O N CF 10' W/O BCR @ NE COR ESPUELLA DR & BOUQUET CYN RD MKD (204-2-1966)	L 3823
NEWHALL (2009)	1,298.676 395.838	CS MON IN NE CONC LEG W&P TOWER #12A6, 150' W/O C/L BOUQUET CYN RD & 115' S/O C/L SUTTERS POINTE DR MKD (BM 204-7-1966)	L 3825
NEWHALL (2009)	1,377.287 419.798	RDBM TAG IN W CB BOUQUET CYN RD 8' S/O BCR 43' W/O C/L & 56' S/O C/L STEVE JON ST	L 3826
NEWHALL (2009)	1,366.343 416.463	FC DISK MON IN CB 118' N & 20' W/O C/L INT RUSS JAY ST & BOUQUET CYN RD MKD (BM 144-00910 1972)	L 3827
NEWHALL (2009)	1,421.462 433.263	CSBM MON W END OF S CB BRIDGE OVER WASH 320' SE/O BOUQUET CYN RD @ ENT RD TO LA CO PROBATION CAMP (#28700) MKD BM 204-10 1966 RE 5869	L 3829
NEWHALL (2009)	1,421.485 433.270	FC MON @ E END S CB BRIDGE OVER WASH 370' SE/O BOUQUET CYN RD @ ENT RD TO LA CO PROBATION CAMP (#28700) MKD (BM 144-01100 1963)	L 3830
NEWHALL (2009)	2,513.300 766.056	CSBM MON 6IN UP 28FT S C/L DAVENPORT RD & 80FT W C/L CORDER RD (PVT) 15FT E/O DRWY TO HSE #11582 MKD (BM 207-10 1967 RE 5869)	L 3940
NEWHALL (2009)	2,492.562 759.735	L&T IN CONC HDWL OF WLY MOST CULV 20' N/O C/L DAVENPORT RD & 486' W/O C/L ADOBE WAY TO TH S (PVT) @ MI MKR #2.96	L 3941
NEWHALL (2009)	2,501.981 762.606	CS MON 1' UP 111' N C/L DAVENPORT RD & 151' E/O C/L TRAIL RD S 16' E C/L DIRT DR TO HSE #11890 MKD (28-27-33-34) 7' E/O E GATE POST (98' E/O MI MRK #2.86)	L 3942
NEWHALL (2009)	2,485.621 757.620	RDBM TAG @ ANGLE PT OF CONC HDWL 18' N/O C/L DAVENPORT RD & 230' W/O C/L TRAIL RD @ MI MKR #2.80	L 3943
NEWHALL (2009)	2,455.769 748.521	CSBM MON 0.5' UP 39' S/O C/L DAVENPORT RD & 38' E/O C/L HASKETT RD 5' S/O PP (NO #) MKD (BM 207-8 1967 RE 5869)	L 3944
NEWHALL (2009)	2,196.433 669.475	CSBM MON 26' S C/L DAVENPORT RD & 0.6MI W/O C/L SUMMIT KNOLL RD 6' SW/O PP (NO #) 400' E/O MI MKR #1.24 MKD (BM 207-4 1967)	L 3947
NEWHALL (2009)	2,069.678 630.840	CSBM MON 33' N C/L DAVENPORT RD & 790' E/O PONTE CORVO RD 39' W/O PP (NO #) 230 E/O MI MKR #0.27 MKD (BM 207-1 1967 RE 5869) 2" IP 2' W/O MON	L 3949
NEWHALL (2009)	1,265.524 385.733	L&T IN N CB 20' N/O C/L NEWHALL AVE & 20' E/O C/L PROD MARKET ST (TO THE S)	L 3950
NEWHALL (2009)	1,257.758 383.366	L&SPK IN N CB 3'E/O BCR @ NE COR NEWHALL AVE & 8TH ST (TO THE NLY)	L 3952
NEWHALL (2009)	1,250.706 381.216	FC TAG IN CB 2' W/O BCR @ SW COR NEWHALL AVE & LYONS AVE	L 3953
NEWHALL (2009)	1,250.124 381.039	L&T IN N CB LYONS AVE 43' N/O C/L ON C/L PROD PEACHLAND AVE	L 3957
NEWHALL (2009)	1,250.538 381.165	L&SPK IN W CB 5' S/O BCR @ SW COR LYONS AVE & PEACHLAND AVE	L 3958

QUAD YEAR	ELEV FOOT/METER	DESCRIPTION	BM NUMBER
NEWHALL (2009)	1,260.455 384.188	RDBM TAG IN S CB 1' E/O BCR @ SE COR LYONS AVE & FOURL RD	L 3959
NEWHALL (2009)	1,040.424 317.122	RDBM TAG IN NE COR HDWL BRIDGE #53-09 20' E/O C/L THE OLD RD & 528' S/O LIVE OAK RD	L 3975
NEWHALL (2009)	1,066.386 325.035	RDBM TAG IN E CB THE OLD RD 15' E/O C/L & 0.4MI N/O SEDONA WAY 2' W/O PP #4456651E	L 3979
NEWHALL (2009)	1,094.755 333.682	RDBM TAG IN E CB THE OLD RD 15' E/O C/L & 0.3MI N/O HILLCREST PKWY OPP BLDG #30629 (72 NE/O F HYD)	L 3983
NEWHALL (2009)	1,114.350 339.655	DEPT WATER RESOURCES MON IN HDWL 25' W C/L THE OLD RD & 0.6MI N/O HILLCREST PKWY 72' SE PP #1871281E MKD 'SUB BM 42 1968' @ MI MKR #2.41	L 3984
NEWHALL (2009)	1,123.478 342.437	RDBM TAG IN E CB THE OLD RD 15' E/O C/L & 40' S/O C/L AC APRON TO CONC DRWY BLDG #31001 'THE OLD ROAD' (66' E/O PP (#1871286E))	L 3985
NEWHALL (2009)	1,125.837 343.156	USC&GS MON 0.2' UP 56' W C/L THE OLD RD & 40' S/O C/L AC APRON & CONC DRWY BLDG #31001 'THE OLD ROAD' 7' W/O PP (1871286E) MKD (R-970 RESET 1967) MKR 2' S/O MON	L 3986
NEWHALL (2009)	1,187.040 361.811	USC&GS MON IN TOP OF RAIL NW COR BRIDGE #B 1778 17'M N/O C/L PARKER RD & 20' E/O (5 FRWY) ON RAMP MKD (F 1219 1971)	L 3988
NEWHALL (2009)	1,283.501 391.212	RDBM TAG IN N CB MC BEAN PKWY 43' N/O C/L & 144' W/O C/L SINGING HILLS RD	L 4233
NEWHALL (2009)	1,213.910 370.001	RDBM TAG IN N CB @ NE COR AVENIDA NAVARRE & MC BEAN PKWY 77' E & 30' N/O C/L INT, 10' E/O BCR	L 4236
NEWHALL (2009)	1,012.182 308.514	CSBM MON IN CONC BASE OF FLAG POLE @ LA CO FIRE STA #76 85' N/O C/L HENRY MAYO DR & 0.2MI W/O THE OLD RD MKD (BM 106-31 1966 RE 5869)	L 4511
NEWHALL (2009)	947.930 288.930	FC MON @ SE COR CONC BRIDGE 15' S/O C/L WALNUT ORCHARD RD & 182' W/O C/L CHIQUITO CYN RD MKD (BM 147-00000 1965)	L 4519
NEWHALL (2009)	982.004 299.316	FC MON IN SW COR OF BRIDGE 15' W/O C/L CHIQUITO CYN RD & 0.3MI N/O HENRY MAYO DR (126) MKD (BM 147-00150 1965)	L 4520
NEWHALL (2009)	1,057.219 322.241	FC BM MON 33' E C/L CHIQUITO CYN RD & 0.75MI N/O HENRY MAYO DR (HWY 126) 33' S/O PP #1882927E MKD (BM 147-00440 1965) 2" IP 3' W/O MON (0.6MI S/O LINCOLN AV)	L 4521
NEWHALL (2009)	1,282.834 391.009	CSBM MON 3' ABOVE ROADWAY DEL VALLE RD 29' E/O C/L & 0.4MI S/O HASLEY CYN RD 30' N/O C/L DIRT RD TO E & 10' S/O PP#4388320E MKD (BM 205-6 1966 RE 5869) 2" IP 1' W/O MON	L 4524
NEWHALL (2009)	1,405.017 428.250	RDBM TAG IN CONC HDWL 61' W/O C/L THE OLD RD & 0.2MI S/O NLY DRIVE TO POST OFFICE @ MI MKR #13.39	L 4535
NEWHALL (2009)	1,621.048 494.097	RDBM TAG IN MCR @ E END ISLAND CB 8' E/O BCR NR C/L THE OLD RD 0.6MI NLY OF WELDON CYN RD @ DRIVE TO HSE#23110	L 4542
NEWHALL (2009)	1,623.824 494.943	RDBM TAG IN MCR @ W END ISLAND CB 7' W/O BCR NR C/L THE OLD RD 0.6MI NLY OF WELDON CYN RD @ DRIVE TO HSE#23110	L 4543

QUAD YEAR	ELEV FOOT/METER	DESCRIPTION	BM NUMBER
BASELINE (2009)	3,154.746 961.569	CSBM MON 40' W/O C/L CROWN VALLEY RD & 0.15MI N/O C/L SILVER SPUR LN 179' N/O PP #2242121E MKD (BM GM-1 RE 5869)	L 4553
NEWHALL (2009)	1,384.843 422.101	RDBM TAG IN SE COR CONC BASE OF FIRE HYD 20' S/O C/L HASLEY CYN RD 69' E/O C/L W MOST ENT TO MOBLE HOME PARK 0.15MI E/O ROMERO CYN RD 40' W/O PP #1001579H	L 4562
NEWHALL (2009)	1,542.265 470.084	RDBM TAG IN SE COR OF CONC FIRE HYD 16' S/O C/L HASLEY CYN RD & 26' E/O C/L GILMOUR RD	L 4566
NEWHALL (2009)	1,598.344 487.177	FC MON IN S EDGE CONC BASE OF F HYD 16' S/O C/L HASLEY CYN RD & 1.2MI W/O ROMERO CYN RD 49' E/O END OF CO RD MKD (BM 142-22305 1972) 30' W/O PP	L 4568
NEWHALL (2009)	1,344.175 409.706	RDBM TAG IN SW COR OF CONC F HYD PAD 30' E/O C/L SLOAN CYN RD & 0.2MI N/O HASLEY CYN RD & 161' S/O C/L 1ST DIRT RD (TO W)	L 4577
NEWHALL (2009)	1,388.314 423.159	RDBM TAG IN SE COR OF CONC F HYD PAD 27' E/O C/L SLOAN CYN RD & .45MI N/O HASLEY CYN RD	L 4578
NEWHALL (2009)	1,184.248 360.960	RDBM TAG IN N CB SOLEDAD CYN RD 44' N/O C/L & 0.5MI E/O BOUQUET CYN RD 15' W/O PP #1504509E OPP SANTA CLARITA WATER CO OFFICE	L 4583
NEWHALL (2009)	1,184.898 361.158	RDBM TAG IN S CB SOLEDAD CYN RD 44' S/O C/L & 0.5MI E/O BOUQUET CYN RD 20' E/O DRWY TO SANTA CLARITA WATER CO OFFICE (3' E/O FIRE HYD)	L 4584
NEWHALL (2009)	1,215.446 370.469	RDBM TAG IN W END C B 46' S/O C/L SOLEDAD CYN RD & 0.35MI W/O GOLDEN OAK RD (10' E/O RR CULV #448.29)	L 4586
NEWHALL (2009)	1,330.151 405.431	RDBM TAG IN CONC BASE OF TRAFFIC LT 13' E/O BCR @ NW COR SOLEDAD CYN RD & LANGSIDE AVE	L 4587
NEWHALL (2009)	1,369.376 417.387	RDBM TAG IN S CB 5' W/O BCR & SW COR SOLEDAD CYN RD & WHITES CYN RD	L 4590
NEWHALL (2009)	1,504.209 458.484	L&T IN N CB 3' E/O BCR @ NE COR SOLEDAD CYN RD & DEEP CREEK DR 60' E & 45' N/O C/L INT	L 4595
NEWHALL (2009)	1,556.220 474.337	L&BR IN N CB SOLEDAD CYN RD 7' W/O BCR 43' N/O C/L & 60' W/O C/L ANNE FRED A ST MKD (BM)	L 4596
NEWHALL (2009)	1,558.109 474.913	RDBM TAG IN N CB SOLEDAD CYN RD 8' E/O BCR 43' N/O C/L & 62' E/O C/L ANNE FRED A ST	L 4597
NEWHALL (2009)	1,579.576 481.456	RDBM TAG IN N CB SOLEDAD CYN RD 5' W/O BCR 43' N/O C/L & 59' W/O C/L GAILXY AVE	L 4598
NEWHALL (2009)	1,579.274 481.364	RDBM TAG IN N CB 5' E/O BCR @ NE COR SOLEDAD CYN RD & GAILXY AVE 60' E & 42' N/O C/L INT	L 4599
NEWHALL (2009)	1,149.994 350.519	SM SPK&LARGE TAG #D-S25 @ SW END OF BRIDGE #B-1552 15' S/O C/L LAKE HUGHES RD & 0.22MI E/O RIDGE RTE RD	L 4622
NEWHALL (2009)	1,153.549 351.603	RD DEPT MON IN WELL ON C/L LAKE HUGHES RD @ BC 0.30MI E/O RIDGE RTE RD (141' E/O E END BRIDGE) 48' E/O C/L INT W/ENT TO CASTIAC REC AREA 10' S/O C/L	L 4623

QUAD YEAR	ELEV FOOT/METER	DESCRIPTION	BM NUMBER
NEWHALL (2009)	1,240.106 377.985	RD DEPT MON ON C/L LAKE HUGHES RD @ BC & @ INT WITH C/L DIRT RD (TO THE E) 35' N/O MI MKR #22.42 (0.60MI E/O RIDGE RTE RD)	L 4625
NEWHALL (2009)	2,035.861 620.532	RD DEPT MON IN WELL ON C/L LAKE HUGHES RD @ EC 158' S/O MI MKR #18.20 & 4.8MI N/O RIDGE RTE RD	L 4642
NEWHALL (2009)	2,103.641 641.192	L&T IN CONC HDWL 33' E/O C/L LAKE HUGHES RD & 330' N/O MI MKR #17.75 (5.3MI N/O RIDGE RTE RD)	L 4643
NEWHALL (2009)	2,086.011 635.818	L&T IN CONC HDWL 30' W/O C/L LAKE HUGHES RD & 0.80MI N/O MI MKR #17.96 (5.8MI N/O RIDGE RTE RD)	L 4645
NEWHALL (2009)	2,023.410 616.737	L&T IN CONC HDWL 30' W/O C/L LAKE HUGHES RD & 0.22MI N/O MI MKR #16.80 (6.4MI N/O RIDGE RTE RD)	L 4647
NEWHALL (2009)	2,025.613 617.409	L&T IN CONC HDWL 30' E/O C/L LAKE HUGHES RD & 0.26MI N/O MI MKR #16.80 (6.5MI N/O RIDGE RTE RD)	L 4648
NEWHALL (2009)	2,039.133 621.530	RD MON IN WELL ON C/L LAKE HUGHES RD @ EC 50' N/O C/L DRY GULCH RD & 6.8MI N/O RIDGE RTE RD (23' N/O MI MKR #16.30)	L 4650
NEWHALL (2009)	1,201.795 366.308	RDBM TAG IN C B 26' N/O BCR @ NW COR BOUQUET CYN RD & SECO CYN RD	L 4811
NEWHALL (2009)	1,270.140 387.140	RDBM TAG IN E CB BOUQUET CYN RD 43' E/O C/L & 76' S/O C/L CENTURION WAY	L 4812
NEWHALL (2009)	1,266.339 385.981	L&T IN CTR OF CB RET @ NW COR BOUQUET CYN RD & CENTURION WAY	L 4813
NEWHALL (2009)	1,353.476 412.541	RDBM TAG IN W CB BOUQUET CYN RD 25' N/O BCR 43' W/O C/L & 70' N/O C/L PLUM CYN RD	L 4815
NEWHALL (2009)	1,164.151 354.834	RDBM TAG IN W CB BOUQUET CYN RD 70' S/O BCR @ SW COR 190' S & 45' W/O C/L INT VALENCIA BLVD & BOUQUET CYN RD	L 4818
NEWHALL (2009)	1,409.540 429.629	RDBM TAG IN S CB 3' W/O BCR @ SW COR SOLEDAD CYN RD & VILNA AVE	L 4819
NEWHALL (2009)	1,451.941 442.553	RDBM TAG IN S CB 5' W/O BCR @ SW COR SOLEDAD CYN RD & RIVER CIRCLE 60' W & 43' S/O C/L INT @ THE 18060 BLOCK	L 4821
NEWHALL (2009)	1,453.503 443.029	RDBM TAG IN S CB 1' E/O BCR @ SE COR SOLEDAD CYN RD & RIVER CIRCLE 60' E & 43' S/O C/L INT @ THE 18060 BLOCK	L 4822
NEWHALL (2009)	1,489.750 454.077	RDBM TAG IN S CB 3' W/O BCR @ SW COR SOLEDAD CYN RD & LOST CYN RD 43' S & 49' W/O C/L INT	L 4823
NEWHALL (2009)	1,491.447 454.594	RDBM TAG IN S CB 1' E BCR @ SE COR SOLEDAD CYN RD & LOST CYN RD 43' S & 50' E/O C/L INT	L 4824
NEWHALL (2009)	1,566.687 477.528	RCE TAG #13095 IN S CB @ SE COR SOLEDAD CYN RD & OAK SPRINGS CYN RD (@ C B)	L 4825
NEWHALL (2009)	1,566.781 477.556	L&RCE TAG #13095 IN N CB @ NE COR SOLEDAD CYN RD & OAK SPRINGS CYN RD (@ C B)	L 4826

QUAD YEAR	ELEV FOOT/METER	DESCRIPTION	BM NUMBER
NEWHALL (2009)	217.831 66.395	CS MON FL 47' S C/L SOLEDAD CYN RD & 0.81MI E/O USFS SOLEDAD CAMP GRND & 390' W/O DRWY HSE#9411 (@ STORE) 60' E/O GUY POLE #829299H MKD (RAVENA A-8 RM #21975) 2" IP 2' E/O MON	L 4828
NEWHALL (2009)	1,996.581 608.560	RDBM TAG IN S END HDWL CULV 20' E/O C/L SIERRA HWY & 0.3MI N/O DAVENPORT RD (72' N/O PP #829371H) @ MI MRK 40.99	L 4831
NEWHALL (2009)	2,724.646 830.475	CE TAG IN SW COR OF TELEPHONE BOX 48' N & 79' W/O C/L INT SIERRA HWY & AGUA DULCE CYN RD	L 4834
NEWHALL (2009)	3,243.060 988.488	RDBM TAG IN W END HDWL CULV 20' S/O C/L SIERRA HWY & 200' W/O C/L SHANNONDALE RD NR MI MKR #30.92	L 4835
NEWHALL (2009)	2,161.341 658.779	SPK IN SE COR OF BRIDGE #B-1459 18' N/O END 15' E/O C/L AGUA DULCE CYN RD & 0.3MI S/O (14) FRWY	L 4837
NEWHALL (2009)	2,479.345 755.707	SPK IN 2" IP IN WELL 1.8' DN @ C/L INT AGUA DULCE CYN RD & DAVENPORT RD	L 4838
NEWHALL (2009)	2,489.375 758.764	RDBM TAG IN CTR OF CONC HDWL 236' N & 15' W/O C/L INT AGUA DULCE CYN RD & ESCONDIDO CYN RD @ MI MKR #1.96	L 4839
NEWHALL (2009)	1,394.784 425.131	RCE TAG #13095 IN S CB 2' E/O BCR @ SE COR PLUM CYN RD & ROGERS DR	L 4843
NEWHALL (2009)	1,392.195 424.342	RCE TAG #13095 IN S CB 3' W/O BCR @ SW COR PLUM CYN RD & ROGERS DR	L 4844
NEWHALL (2009)	1,443.867 440.092	2" IP W/BR CAP 44' E/O C/L SAN FRANCISQUITO CYN RD & 1¼MI S/O POWER HSE #2 7' N/O ANG NATL FORREST BNDRY SIGN MKD (LA CO RD DEPT BM 1984) 2" IP 2' W/O MON	L 4847
NEWHALL (2009)	1,584.445 482.940	RDBM TAG IN CONC BASE OF ST LT @ SW COR SAND CYN RD & SOLEDAD CYN RD 82' W & 48' S/O C/L INT	L 5000
NEWHALL (2009)	1,608.089 490.147	LA CO BM TAG N CB 3' W/O BCR @ NW COR SOLEDAD CYN RD & FLOWERPARK DR	L 5003
NEWHALL (2009)	1,610.117 490.765	RDBM TAG IN E CB 3' N/O BCR @ NE COR SOLEDAD CYN RD & FLOWERPARK DR	L 5004
NEWHALL (2009)	1,673.708 510.148	L&BN IN BASE OF ST LT @ SELY COR SOLEDAD CYN RD & N BOUND (14) FRWY OFF-RAMP 65' ELY & 36' SLY OF C/L INT (36' WLY/O PP #1482774E) S SIDE FRWY	L 5009
NEWHALL (2009)	1,771.339 539.906	RDBM TAG IN SE COR DROP INLET DRAIN 18' N/O C/L SOLEDAD CYN RD & 0.45MI E/O LANG STATION RD (@ MI MKR #10.41) (OPP PP#4301309E)	L 5010
NEWHALL (2009)	1,758.196 535.900	L&BN NR MOC OF ROCK & CONC FOUNTAIN @ ENT TO RIVERS END PARK & CAMPGROUND 39' S/O C/L SOLEDAD CYN RD & 17' W/O ENT GATE MKD (BM)	L 5012
NEWHALL (2009)	1,834.410 559.130	RDBM MON 25' N/O C/L SOLEDAD CYN RD & 0.25MI W/O CAPRA RD 7' NW/O PP (NO #) 15' E/O MI MKR #11.89 (2" IP 2' S/O MON)	L 5013
NEWHALL (2009)	1,901.322 579.525	RDBM TAG IN CTR OF HDWL CULV 30' N/O C/L SOLEDAD CYN RD & 10' W/O C/L INT WITH CAPRA RD (TO S)	L 5014

QUAD YEAR	ELEV FOOT/METER	DESCRIPTION	BM NUMBER
NEWHALL (2009)	1,962.405 598.143	RDBM TAG 1' N/O CF @ TUNNELS (E PORTAL) 15' N/O C/L SOLEDAD CYN RD & 1MI W/O AGUA DULCE CYN RD	L 5015
NEWHALL (2009)	1,962.468 598.162	RDBM TAG 1' S/O CF @ TUNNELS (E PORTAL) 15' N/O C/L SOLEDAD CYN RD & 1MI W/O AGUA DULCE CYN RD	L 5016
NEWHALL (2009)	1,972.423 601.196	RDBM TAG IN W END OF HDWL CULV 18' N/O C/L SOLEDAD CYN RD & 0.35MI E/O AGUA DULCE CYN RD (@ MI MKR #13.86)	L 5018
NEWHALL (2009)	1,980.722 603.726	RDBM TAG IN CTR HDWL 37' S/O C/L SOLEDAD CYN RD & 0.60MI E/O AGUA DULCE CYN RD (@ MI MKR #14.12)	L 5019
NEWHALL (2009)	2,019.592 615.573	RDBM TAG IN CTR HDWL CULV 50' S/O C/L SOLEDAD CYN RD & 0.87MI E/O AGUA DULCE CYN RD @ MI MRK #14.40	L 5020
NEWHALL (2009)	2,030.921 619.027	RDBM TAG IN E END HDWL CULV 20' S C/L SOLEDAD CYN RD & 0.40MI E/O ENT TO (WHITE ROCK LAKE CAMP GROUNDS) @ MI MKR #14.95	L 5021
NEWHALL (2009)	2,081.292 634.380	RDBM TAG IN W WALL OF CULV 27' S/O C/L SOLEDAD CYN RD & 0.25MI E/O USFS SOLEDAD CAMP GROUND (@ MI MKR #15.38)	L 5022
NEWHALL (2009)	2,151.461 655.767	RDBM TAG IN FTG @ NE COR BRICK PILLAR @ RANCH #9070 SOLEDAD CYN RD 30' S/O C/L & 0.28MI W/O LACO FIRE CAMP #11 (250' E/O SE COR BRIDGE #B-910)	L 5025
NEWHALL (2009)	2,168.055 660.825	RDBM TAG S END W WING WALL BRIDGE #903 @ ENT TO LACO FIRE CAMP #11 (28' S/O C/L SOLEDAD CYN RD)	L 5026
NEWHALL (2009)	2,209.877 673.573	RDBM TAG IN W WING WALL BRIDGE #B-873 15' S/O C/L SOLEDAD CYN RD & 0.50MI E/O LACO FIRE CAMP #11	L 5027
NEWHALL (2009)	2,258.811 688.488	RDBM TAG W END IN S HDWL CULV 25' S/O SOLEDAD CYN RD & 700' E/O INDIAN CYN RD (N) @ MI MKR #17.74	L 5028
NEWHALL (2009)	2,271.580 692.380	RDBM TAG E END OF S ROCK HDWL CULV 17' S C/L SOLEDAD CYN RD & 131' W/O C/L DIRT DRWY TO HSE #7433-7511 (N) @ MI MKR #18.12	L 5029
NEWHALL (2009)	2,315.325 705.713	RDBM TAG E END HDWL CULV 25' S C/L SOLEDAD CYN RD & 34' E/O C/L DRWY TO HSE #7036 @ INT WITH HUGHS CYN RD (N) @ MI MKR #18.63	L 5030
NEWHALL (2009)	2,367.239 721.537	RDBM TAG IN NWLY ABUT OF BR #B-904 OVER SANTA CLARA RIVER & SPRR 15' N/O C/L SOLEDAD CYN RD (E/O HUGHS CYN RD)	L 5031
NEWHALL (2009)	2,379.285 725.208	RDBM TAG IN SELY ABUT TO BR #B-904 OVER SANTA CLARA RIVER & SPRR 15' SLY/O C/L SOLEDAD CYN RD (E/O HUGHS CYN RD)	L 5032
NEWHALL (2009)	2,442.736 744.548	RDBM TAG W END HDWL CULV 26' S/O SOLEDAD CYN RD & 0.87MI E/O SANTA CLARA RIVER BR 49' S/O PP #1661086E (NR MI MKR #19.97)	L 5033
NEWHALL (2009)	2,532.921 772.037	RDBM TAG IN CONC BASE SLY LEG EDISON TOWER #24/3 69' NLY C/L SOLEDAD CYN RD & 0.25MI E/O BOOTLEGGERS CYN RD (49' N/O MI MKR #20.84)	L 5034
NEWHALL (2009)	2,677.931 816.236	L&BN IN ROCK & CONC WING WALL 39' N/O C/L ESCONDIDO CYN RD & 203' E/O C/L HANAWALT RD (PVT) 25' N/O MI MKR #1.20	L 5037
NEWHALL (2009)	2,727.922 831.473	L&BN IN CONC HDWL 36' N/O C/L ESCONDIDO CYN RD & 33' W/O PP #640489H (16' N/O MI MKR #1.65)	L 5038

QUAD YEAR	ELEV FOOT/METER	DESCRIPTION	BM NUMBER
NEWHALL (2009)	2,855.964 870.500	L&BN IN CONC HDWL 20' N C/L ESCONDIDO CYN RD & 580' E/O C/L ELY MOST DRWY TO HSE #9235 @ MI MKR #2.07	L 5039
NEWHALL (2009)	2,881.562 878.303	CSBM MON 92' S/O C/L SIERRA HWY & 951' E/O ANTHONY RD & 6' E/O C/L PROD JOHNNIE RD (DIRT PVT) FR N 62' SELY/O PP #2366436E MKD (BM 201- 82A 1968 RE 5869) 2" IP 3' NWLY/O MON	L 5042
NEWHALL (2009)	3,242.780 988.402	CSBM MON IN CONC HDWL CULV 25' NLY C/L SIERRA HWY & 190' WLY/O C/L SHANNONDALE RD @ MI MKR #30.92 MKD (BM 201-77A 1968)	L 5044
NEWHALL (2009)	3,007.874 916.803	RDBM TAG IN SE COR CONC BASE OF FIRE HYD 20' N/O C/L SIERRA HWY & 0.60MI E/O RED ROVER MINE RD	L 5045
NEWHALL (2009)	2,489.120 758.686	CS MON IN WELL @ C/L INT AQUA DULCE CYN RD & ESCONDIDO CYN RD MKD (LACE 1/4 COR T5N,R14W,27, 26,RE 5869)	L 5049
NEWHALL (2009)	2,251.429 686.238	RDBM TAG IN CTR OF S WINGWALL CULV 23' W/O C/L AGUA DULCE CYN RD & 0.6MI N/O (14) FRWY @ MI MKR #3.21	L 5051
NEWHALL (2009)	2,214.423 674.958	CSBM MON 33' W/O C/L AGUA DULCE CYN RD OPP SLY ENT TO VASQUEZ PARADISE PARK NR MI MKR #3.34 MKD (BM 202-39A 1973) 2"IP IP 2' E/O MON	L 5052
NEWHALL (2009)	2,213.512 674.680	CSBM MON 26 N C/L DAVENPORT RD & 90' E/O C/L ATLER RD 8' W/O PP (NO #) MKD (BM 207-2A 1973 RE 7078) IP MKR 1' S/O MON	L 5054
NEWHALL (2009)	1,689.766 515.042	LS TAG #2602 IN S CB 3' W/O BCR SW COR STEINWAY ST & HOT SPRINGS AVE	L 5056
NEWHALL (2009)	1,688.130 514.544	LS TAG #2602 IN S CB @ SW COR STEINWAY ST & WHITES CYN RD 105' W & 18' S/O C/L INT	L 5057
NEWHALL (2009)	1,582.257 482.273	RDBM TAG IN N CB 5' W/O BCR @ NW COR SOLEDAD CYN RD & KENROY AVE 43' N & 72' W/O C/L INT	L 5068
NEWHALL (2009)	1,696.070 516.964	USC&GS MON IN S END CONC HDWL 39' E/O C/L SIERRA HWY & 0.7MI S/O REMSEN ST (E) MKD (G 1145 1961)	L 5071
NEWHALL (2009)	1,577.555 480.840	RDBM TAG IN SE COR CONC HDWL 47' W/O C/L SIERRA HWY & 249' N/O (14) FRWY 135' S/O PP #1865796E (0.7MI N/O THE OLD RD), MM 51.32	L 5072
NEWHALL (2009)	1,446.807 440.988	LACO TAG IN W CB 20' W C/L SIERRA HWY & 7' N/O BRIDGE #53-391 236' N/O C/L THE OLD ROAD	L 5073
NEWHALL (2009)	1,447.071 441.069	L&T IN W CB @ SW COR OF BRIDGE #BR53-391 4' N/O BCR NW COR SIERRA HWY & THE OLD ROAD, 20' W & 57' N/O C/L INT MKD (CH)	L 5074
NEWHALL (2009)	1,557.870 474.840	RDBM TAG IN NW COR C B 21' W/O APPROX C/L THE OLD ROAD & 2100'N/O SIERRA HWY 175' N/O FRWY OFF-RAMP & 94' SELY/O PP #1997482E	L 5077
NEWHALL (2009)	1,619.648 493.670	CSBM MON IN SW COR C B 22' S/O APPROX C/L THE OLD ROAD & 1000' W/O FRWY OFF RAMP & 354' E/O ENT TO HSE#22400 MKD (BM 60-12A 1973)	L 5078

QUAD YEAR	ELEV FOOT/METER	DESCRIPTION	BM NUMBER
NEWHALL (2009)	1,711.847 521.773	CSBM MON IN SW COR C B 20' W/O C/L THE OLD RD & 1584' S/O WELDON CYN RD & 0.2MI W/O C/L DR HSE#22400 MKD (BM 60-13A 1973)	L 5079
NEWHALL (2009)	1,263.896 385.237	RDBM TAG IN S CB 2' W/O BCR @ SW COR LYONS AVE & VALLEY ST	L 5080
NEWHALL (2009)	1,264.491 385.418	RDBM TAG IN S CB 6' W/O BCR @ SE COR LYONS AVE & VALLEY ST	L 5081
NEWHALL (2009)	1,263.267 385.045	CSBM MON IN E END OF C B @ SE COR LYONS AVE & WAYMAN ST MKD (BM 60-36D 1976 RE 22726)	L 5082
NEWHALL (2009)	1,391.739 424.203	RDBM TAG IN E END C B 20' N/O C/L BOUQUET CYN RD & 44' W/O C/L HOB AVE	L 5084
NEWHALL (2009)	1,317.966 401.717	RDBM TAG IN E CB TOURNAMENT RD 20' E/O C/L & 20' S/O C/L VISTA HILLS DR	L 5085
NEWHALL (2009)	1,318.610 401.914	RDBM TAG IN W CB TOURNAMENT RD 20 W/O C/L & 62' N/O C/L VISTA HILLS DR	L 5086
NEWHALL (2009)	1,262.203 384.721	RDBM TAG IN E CB TOURNAMENT RD 3' S/O BCR 20' E/O C/L & 48' S/O C/L GOLF COURSE RD	L 5087
NEWHALL (2009)	1,262.978 384.957	RDBM TAG IN S CB GOLF COURSE RD 3' W/O BCR 20' S/O C/L & 47' W/O C/L TOURNAMENT RD	L 5088
NEWHALL (2009)	1,357.273 413.698	RDBM TAG IN W CB 3' S/O BCR @ SW COR MC BEAN PKWY & TOURNAMENT RD 79' S & 33' W/O C/L INT	L 5089
NEWHALL (2009)	1,353.411 412.521	RDBM TAG IN S CB 1' E/O BCR @ SE COR MC BEAN PKWY & TOURNAMENT RD 69' E & 43' S/O C/L INT	L 5090
NEWHALL (2009)	1,247.257 380.165	RDBM TAG IN W CB 2' S/O BCR OF SLY EXIT DRWY COLLEGE OF THE CYNS PKG LOT 33' W/O C/L ROCKWELL CYN RD & 2600' N/O MC BEAN PKWY	L 5091
NEWHALL (2009)	1,244.133 379.213	RDBM TAG E CB ROCKWELL CYN RD 7' S/O C B 30' E/O C/L & 53' N/O C/L PROD COLLEGE OF THE CYNS PKG LOT SLY EXIT DRWY (2600' N/O MC BEAN PKWY)	L 5092
NEWHALL (2009)	1,214.816 370.277	L&BN IN E CB 2' S/O BCR @ SE COR VALENCIA BL & ROCKWELL CYN RD 33' E & 77' S/O C/L INT	L 5093
NEWHALL (2009)	1,231.828 375.462	CSBM MON 3" UP 49' W/O C/L DEL VALLE RD & 0.1MI NELY/O SILVER ST MKD (BM 205-5A RE 7078) 2" IP 2' E/O MON	L 5095
NEWHALL (2009)	1,350.072 411.503	CSBM MON 3" UP @ CREST OF HILL 34' E/O C/L DEL VALLE RD & 0.5MI NELY OF SILVER ST MKD (BM 205-5B 1973) 2" IP MKR 2' W/O MON (0.6MI S/O C/L HASLEY CYN RD)	L 5096
NEWHALL (2009)	1,384.059 421.862	RDBM TAG IN N CB 6' E/O BCR @ NE COR WHITES CYN RD & NADAL ST	L 5113
NEWHALL (2009)	1,381.064 420.950	RDBM TAG IN W CB 5' N/O BCR @ NW COR WHITES CYN RD & NADAL ST	L 5114

QUAD YEAR	ELEV FOOT/METER	DESCRIPTION	BM NUMBER
NEWHALL (2009)	1,497.161 456.336	RDBM TAG IN E END C.B. 1' N/O CF 43' N/O C/L WHITES CYN RD & 285' E/O C/L CANYON CREST DR	L 5115
BASELINE (2009)	2,757.450 840.473	L&T IN W CB CROWN VALLEY RD 43' W/O C/L & ¼ MI S/O ALISO ST (28' S/O LT STD #4117960E)	L 5165
BASELINE (2009)	2,761.146 841.600	DPW BM TAG IN W CB CROWN VALLEY RD 43' W/O C/L & 0.20 MI S/O ALISO ST (10' S/O LT STD #4117959E)	L 5166
BASELINE (2009)	2,794.817 851.863	L&T IN W CB @ SW COR CROWN VALLEY RD & ALISO ST 120' S & 43' W/O C/L INT	L 5167
BASELINE (2009)	2,855.698 870.419	DPW BM TAG W CB CROWN VALLEY RD 43' W & C/L 16' N/O C/L NLY MOST DRWY TO LA CO WW BUILDING #33025 (OPP PP #1847472E)	L 5168
BASELINE (2009)	2,933.487 894.130	DPW BM TAG E CB CROWN VALLEY RD 43' E/O C/L & 40' S/O C/L N BOUND ON-RAMP (14 FRWY) 2' S/O BCR @ AM-PM GAS STATION	L 5169
BASELINE (2009)	2,965.521 903.894	RDBM TAG IN N CB @ NW COR SIERRA HWY & CROWN VALLEY RD 66' W & 43' N/O C/L INT	L 5170
NEWHALL (2009)	1,061.448 323.530	DPW BM TAG IN E CB 3' N/O END @ SE COR RYE CYN RD & THE OLD RD 85' S & 53' E/O C/L INT	L 5210
NEWHALL (2009)	1,066.111 324.952	DPW BM TAG W CB THE OLD RD 33' W/O C/L & 0.4MI N/O SEDONA WAY @ LT STD #4093815E @ OPP MM 3.63	L 5212
NEWHALL (2009)	1,084.951 330.694	DPW BM TAG IN W CB 1' S/O BCR @ SW COR THE OLD RD & HILLCREST PKWY	L 5213
NEWHALL (2009)	1,521.080 463.627	DPW BM TAG IN CONC FTG OF EDISON PP #4093201E 43' W/O C/L SIERRA HWY & 0.2MI N/O DOCKWEILER DR	L 5216
NEWHALL (2009)	1,593.212 485.612	DPW BM TAG IN S END OF CONC DRWY TO BERRY PETROLEUM CO 43' W/O C/L SIERRA HWY 0.6MI N/O PLACERITA CYN RD	L 5217
NEWHALL (2009)	1,661.402 506.397	DPW BM TAG 1 S/O BCR @ SW COR SIERRA HWY & RAINBOW GLEN DR	L 5220
NEWHALL (2009)	1,458.691 444.610	DPW BM TAG 1' S/O BCR @ SE COR VIA PRINCESSA & SIERRA HWY	L 5221
NEWHALL (2009)	1,476.661 450.088	DPW BM TAG IN S CB AMERICAN BEAUTY DR 2' E/O BCR 26' S/O C/L & 56' E/O C/L SIERRA HWY	L 5223
NEWHALL (2009)	1,519.980 463.291	DPW BM TAG IN W CB SIERRA HWY 7' N/O BCR 43' W/O C/L & 49' N/O C/L HILLFIELD LN	L 5224
NEWHALL (2009)	1,565.838 477.269	DPW BM TAG IN W CB SIERRA HWY 43' W/O C/L 5' S/O DRWY TO MINI STORAGE BLDG #17369 (20' N/O F HYD) 340' S/O C/L LINDA VISTA	L 5225
NEWHALL (2009)	1,593.952 485.838	DPW BM TAG IN W CB SIERRA HWY 43' W/O C/L & 45' N/O CONC DRWY TO STORAGE BLDG #17175 (7' N/O PP #1443621E)	L 5226
NEWHALL (2009)	1,596.089 486.489	DPW BM TAG 1' S/O END CB 43' W/O C/L SIERRA HWY @ NE COR STORAGE BLDG #17175 (21' N/O PP #1443623E)	L 5227
NEWHALL (2009)	1,704.099 519.411	DPW BM TAG IN CTR OF CONC HDWL @ SE COR SIERRA HWY & SAND CYN RD 110' E & 26' S/O C/L INT	L 5228

QUAD YEAR	ELEV FOOT/METER	DESCRIPTION	BM NUMBER
NEWHALL (2009)	1,699.121 517.894	DPW BM TAG 1' W/O C B @ NE COR SIERRA HWY & SAND CYN RD 80' E & 18' W/O C/L INT	L 5229
NEWHALL (2009)	1,721.266 524.643	DPW BM TAG IN N END HDWL 34' W/O C/L SIERRA HWY & 240' N/O C/L VASQUEZ CYN RD	L 5230
NEWHALL (2009)	1,965.323 599.032	DPW BM TAG IN NW COR CONC WATER WELL SLAB @ HSE #14715 72' W/O C/L SIERRA HWY & 150' S/O C/L PROD DAVENPORT RD	L 5231
NEWHALL (2009)	2,115.693 644.865	DPW BM TAG IN CTR CONC HDWL 20' S/O C/L SIERRA HWY & 1.5MI N/O DAVENPORT RD @ MI MKR #39.78	L 5232
NEWHALL (2009)	2,369.317 722.170	RDBM TAG IN W END CONC HDWL 25' S/O C/L SIERRA HWY & 276' W/O SIERRA VALLEJO RD (PVT) @ MI MKR #38.13	L 5235
NEWHALL (2009)	2,368.938 722.054	DPW BM TAG IN W END OF CONC HDWL 50' N/O C/L SIERRA HWY & 285' W/O C/L SIERRA VALLEJO RD @ MI MKR #38.13	L 5236
NEWHALL (2009)	3,382.070 1,030.858	2" IP W/DPW BM TAG 43' N/O C/L SIERRA HWY & 0.30MI W/O ENT (STONE ARCHWAY) (N SIDE) @ #6221 30' E/O PP #4261716E (28' W/O MI MKR #31.54) 0.40MI W/O JUNIPER VALLY RD (PVT)	L 5239
NEWHALL (2009)	1,205.849 367.544	DPW BM TAG S CB @ BCR SE COR SOLEDAD CYN RD & COMMUTER WAY	L 5240
NEWHALL (2009)	1,297.545 395.493	DPW BM TAG IN SW COR C B 49' S/O C/L SOLEDAD CYN RD & 100' E/O C/L HONBY AVE	L 5241
NEWHALL (2009)	1,584.304 482.897	DPW BM TAG IN N CB 1' W/O BCR @ NW COR SOLEDAD CYN RD & SAND CYN RD	L 5242
NEWHALL (2009)	1,942.992 592.226	DPW BM TAG NW COR HDWL 20' N/O C/L SOLEDAD CYN RD & 0.4MI W/O AGUA DULCE CYN RD @ MI MKR 13.10	L 5243
NEWHALL (2009)	2,560.362 780.401	DPW BM TAG 1' S/O SE COR OF GARAGE #33615 AQUA DULCE CYN RD 66' N/O C/L	L 5246
NEWHALL (2009)	2,534.582 772.543	DPW BM TAG IN S EDGE OF CONC DRWY 25' W/O C/L TYNDALL RD & 80' N/O C/L ESCONDIDO CYN RD 1ST HSE NW/O ESCONDIDO CYN RD	L 5247
NEWHALL (2009)	1,721.661 524.764	DPW BM TAG IN CONC DRWY TO HSE #26767, 20' W/O C/L SAND CYN RD & 43' S/O C/L CACHUMA LN (PVT)	L 5248
NEWHALL (2009)	1,546.862 471.485	L&T IN W CB @ NLY END OF BRIDGE #B 3537 OVER SANTA CLARA RIVER 20' W/O C/L SAND CYN RD & 0.2MI N/O LOST CYN RD	L 5249
NEWHALL (2009)	1,633.482 497.887	DPW BM TAG IN W CB 43' N/O BCR @ NW COR SAND CYN RD & SILVER SADDLES CIR (SLY) 85' N & 23' W/O APPROX C/L INT	L 5250
NEWHALL (2009)	1,847.153 563.014	DPW BM TAG IN W WINGWALL @ NW COR BRIDGE 400' W/O C/L SAND CYN RD & 18' N/O C/L PLACERITA CYN RD	L 5251
NEWHALL (2009)	1,318.612 401.914	CAL-TRANS DISC IN WALK 46' N/O C/L NEWHALL AVE & 235' E/O C/L RACE ST MKD (GPS 0057-1991) 2.5' N/O CF	L 5252
NEWHALL (2009)	1,317.630 401.615	DPW BM TAG IN N CB 1' E/O BCR @ NE COR NEWHALL AVE & RACE ST	L 5253

QUAD YEAR	ELEV FOOT/METER	DESCRIPTION	BM NUMBER
NEWHALL (2009)	1,309.135 399.026	RDBM TAG IN ELY CB 2' N/O BCR @ NE COR RAILROAD AVE & PINE ST 46' NLY & 20' E/O C/L INT	L 5254
NEWHALL (2009)	1,217.936 371.228	DPW BM TAG IN SW COR WINGWALL SPRR BRIDGE 60' E/O C/L RAILROAD AVE & ±¼MI N/O 15TH ST @ MI MKR #9.95	L 5256
NEWHALL (2009)	1,178.015 359.060	DPW BM TAG W CB RAILROAD AVE 43' W/O C/L & 1850' N/O OAK RIDGE DR (8' E/O PP #4235226E) (OPP N MOST TIN BLD#6 ALONG RR)	L 5259
NEWHALL (2009)	1,170.926 356.899	DPW BM TAG IN W CB NR S END C B @ SW COR RAILROAD AVE & DRAYTON ST 46' S/O C/L PROD DRAYTON ST	L 5260
NEWHALL (2009)	1,135.545 346.115	DPW BM TAG E END C B 25' E/O BCR @ SE COR MAGIC MTN PKWY & AUTO CTR DR95' E & 56' S/O C/L INT	L 5263
NEWHALL (2009)	1,151.683 351.034	DPW BM TAG N CB 5' E/O BCR @ NE COR MC BEAN PKWY & VALENCIA BLVD 80' E & 59' N/O C/L INT	L 5267
NEWHALL (2009)	1,188.926 362.386	DPW BM TAG S CB 7' E/O BCR @ SE COR MC BEAN PKWY & ARROYO PARK DR 84' E & 33' S/O C/L INT	L 5268
NEWHALL (2009)	1,171.809 357.168	DPW BM TAG W CB 5' N/O BCR @ NW COR MC BEAN PKWY & GAMBLE HOUSE CT	L 5269
NEWHALL (2009)	948.053 288.967	RCE TAG #16913 IN NW COR CONC BRIDGE 111' W/O C/L CHIQUITO CYN RD & 15' N/O C/L WALNUT ORCHARD DR	L 5273
NEWHALL (2009)	1,356.422 413.439	DPW BM TAG IN NE COR CONC F HYD PAD 20' S/O C/L HASLEY CYN RD & 198' W/O C/L ARROYO OAK LN	L 5280
NEWHALL (2009)	1,475.949 449.871	DPW BM TAG SE COR CONC F HYD PAD 15' S/O C/L HASLEY CYN RD & 0.2 MI W/O VALLEY GLEN CT 60' W/O DRWY TO HSE #30460	L 5281
NEWHALL (2009)	981.463 299.151	DPW BM TAG IN CONC WALL 8' W/O NE COR BRIDGE #5393 OVER CASTAIC CREEK 20' N/O C/L HENRY MAYO DR (HWY 126) & 1.7MI E/O CHIQUITO CYN RD	L 5282
NEWHALL (2009)	1,776.878 541.594	L&T IN ROCK WALL OF DRAIN 16' S C/L VASQUEZ CYN RD & 0.75MI E/O LOST CREEK RD 95' E/O PP#4761518E, @MM 1.34	L 5284
NEWHALL (2009)	1,502.014 457.815	2" IP W/DPW BM TAG 23' W C/L BOUQUET CYN RD & 340' N/O C/L ESQUERRA RD 5' WLY PP (#4093296E) 0.55MI S/O VASQUEZ CYN RD	L 5285
NEWHALL (2009)	1,423.992 434.034	DPW BM TAG IN W CB 5' N/O BCR @ NW COR PLUM CYN RD & VIA JOYCE DR 84' N & 20' W/O C/L INT	L 5286
NEWHALL (2009)	1,543.063 470.327	DPW BM TAG @ NW COR BRIDGE 43' W/O C/L SIERRA HWY & 8' N/O C/L SCHERZINGER LN	L 5288
NEWHALL (2009)	1,345.244 410.032	DPW BM TAG IN N CB 5' E/O BCR @ NE COR SECO CYN RD & COPPER HILL DR 69' E & 33' N/O C/L INT (W END C B)	L 5292
NEWHALL (2009)	1,312.344 400.004	FC MON 28' W/O C/L SAN FRANCISQUITO CYN RD & 108 N/O C/L DRWY TO LE RANCH #29650 (3' N/O PP #783527) MKD (BM 743-02660) 2" IP 2' NW/O MON	L 5295
NEWHALL (2009)	1,506.958 459.322	DPW BM TAG @ NE COR OF BRIDGE #2484 NR N END ABUT 20' E/O C/L SAN FRANCISQUITO CYN RD 0.68MI S/O POWER HSE #2 (1.9MI N/O NATIONAL FORREST SIGN)	L 5297

QUAD YEAR	ELEV FOOT/METER	DESCRIPTION	BM NUMBER
NEWHALL (2009)	1,736.733 529.358	RD MON IN WELL 4" DN 420' NELY/O C/L DRY GULCH RD (DIRT) ON C/L PROD SAN FRANCISQUITO CYN RD & 0.50MI N/O BRIDGE #2486 MKD (RD 1976)	L 5300
NEWHALL (2009)	1,150.382 350.637	DPW BM TAG IN W CB S END C B 34' W/O C/L RIDGE RTE RD & 111' N/O DRWY TO CASTAIC LAKE R V PARK	L 5301
NEWHALL (2009)	1,161.978 354.172	DPW BM TAG IN E CB 2' N/O BCR @ NE COR RIDGE RTE RD & VIOLIN CYN RD 50' N & 33' E C/L INT	L 5302
NEWHALL (2009)	1,164.928 355.071	L&BR IN MCR @ NW COR RIDGE RTE RD & LAKE HUGES RD	L 5303
NEWHALL (2009)	1,099.510 335.132	DPW BM TAG IN NW LEG OF S.C.EDISON TOWER (#0-1) 69' S/O C/L MAGIC MTN PKWY & 135' E/O C/L AC RD TO EDISON FACILITY 1850' E/O TOURNEY RD	L 5307
NEWHALL (2009)	1,125.725 343.122	DPW BM TAG IN W CB 2' N/O BCR @ SW COR MAGIC MTN PKWY & MC BEAN PKWY 85' S & 60' W/O C/L INT	L 5308
NEWHALL (2009)	1,124.445 342.732	DPW BM TAG IN E CB 2' N/O BCR @ NE COR MAGIC MTN PKWY & MC BEAN PKWY	L 5309
NEWHALL (2009)	1,145.279 349.082	DPW BM TAG IN S CB 3' E/O BCR @ SE COR MAGIC MTN PKWY & CITRUS DR	L 5310
NEWHALL (2009)	1,159.575 353.440	DPW BM TAG IN S CB 3' W/O W END DRWY TO APT BLDG #23428 MAGIC MTN PKWY 40' S/O C/L	L 5311
NEWHALL (2009)	1,168.086 356.034	DPW BM TAG IN E CB RAILROAD AVE 53' E/O C/L & 38'M S/O C/L MAGIC MTN PKWY	L 5312
NEWHALL (2009)	1,253.280 382.001	DPW BM TAG IN W CB 3' S/O BCR @ SW COR LYONS AVE & EVERETT	L 5313
NEWHALL (2009)	1,227.234 374.062	DPW BM TAG N CB 8' E BCR @ NE COR MC BEAN PKWY & ORCHARD VILLAGE RD 79' E & 43' N/O C/L INT	L 5314
NEWHALL (2009)	1,128.362 343.926	DPW BM TAG E CB 3' N/O BCR @ NE COR MC BEAN PKWY & TOWN CENTER 69' N & 56' E/O C/L INT	L 5317
NEWHALL (2009)	1,422.614 433.614	DPW BM TAG IN N CB 2' E/O BCR @ NE COR COPPER HILL DR & TAMARACK LN (NR W END C B)	L 5322
NEWHALL (2009)	1,490.619 454.342	DPW BM TAG S CB 3' E/O BCR @ SE COR COPPER HILL DR & PARAGON DR	L 5324
NEWHALL (2009)	1,514.269 461.551	DPW BM TAG S CB 3' W/O BCR @ SW COR COPPER HILL DR & KENTON LN	L 5325
NEWHALL (2009)	1,468.792 447.689	RCE TAG #13095 IN S CB 2' E/O BCR @ SE COR COPPER HILL DR & AGAJANIAN LN	L 5327
NEWHALL (2009)	1,376.713 419.623	DPW BM TAG S CB 15' W/O BCR @ SW COR COPPER HILL DR & HASKELL CYN RD (NR W END C B)	L 5328
NEWHALL (2009)	1,376.207 419.469	RCE TAG #13095 IN W CB 1' S/O BCR @ SW COR HASKELL CYN RD & COPPER HILL DR	L 5329

QUAD YEAR	ELEV FOOT/METER	DESCRIPTION	BM NUMBER
NEWHALL (2009)	1,332.309 406.089	RCE TAG #13095 IN W CB 8' N/O BCR @ NW COR HASKELL CYN RD & JEFFERS LN (NR N END C B)	L 5331
NEWHALL (2009)	1,332.486 406.143	DPW BM TAG IN S CB 16' W/O BCR @ SW COR HASKELL CYN RD & JEFFERS LN	L 5332
NEWHALL (2009)	1,293.428 394.238	RCE TAG #13194 IN S CB 0.5' W/O BCR @ SE COR HASKELL CYN RD & RIDGE GROVE DR	L 5333
NEWHALL (2009)	1,284.318 391.461	L&T IN E CB NR ABUT @ SE COR BRIDGE 15' E/O C/L HASKELL CYN RD & 528' N/O BOUQUET CYN RD	L 5334
NEWHALL (2009)	1,280.055 390.162	L&BR IN W CB HASKELL CYN RD 0.5' N/O BCR 33' W/O C/L & 76' N/O C/L BOUQUET CYN RD	L 5335
NEWHALL (2009)	1,280.641 390.341	L&BR IN N CB, NE COR BOUQUET CYN RD & HASKELL CYN RD 0.5' E/O BCR	L 5336
NEWHALL (2009)	1,192.211 363.387	DPW BM TAG IN W CB RAILROAD AVE 54' W/O C/L & 49' N/O C/L PROD OAK RIDGE DR	L 5337
NEWHALL (2009)	1,309.285 399.071	DPW BM TAG N CB SOLEDAD CYN RD 3' W/O BCR 44' N/O C/L & 39' W/O C/L RAINBOW GLEN DR	L 5343
NEWHALL (2009)	1,311.470 399.737	DPW BM TAG IN S CB SOLEDAD CYN RD 3' E/O BCR 43' S/O C/L & 69' E/O C/L RAINBOW GLEN DR	L 5344
NEWHALL (2009)	1,378.884 420.285	RCE TAG #13095 IN E CB 1' N/O BCR @ NE COR RAINBOW GLEN DR & FLO LN	L 5345
NEWHALL (2009)	1,379.040 420.333	RCE TAG #13095 IN W CB RAINBOW GLEN DR 1' N/O BCR 20' W/O C/L & 49' N/O C/L GILBERT DR	L 5346
NEWHALL (2009)	1,381.979 421.228	DPW BM TAG E CB 3' S/O BCR @ SE COR RAINBOW GLEN DR & HUMMINGBIRD CIR	L 5347
NEWHALL (2009)	1,459.585 444.883	RCE TAG #9553 IN W CB 1' S/O BCR @ SW COR VIA PRINCESSA & RAINBOW GLEN DR	L 5348
NEWHALL (2009)	1,457.872 444.361	DPW BM TAG IN N CB 3' E/O BCR @ NE COR RAINBOW GLEN DR & VIA PRINCESSA 49' E & 33' N/O C/L INT	L 5349
NEWHALL (2009)	1,446.176 440.796	RCE TAG #13095 IN N CB 0.5' E/O BCR @ NE COR VIA PRINCESSA & GREGORY LN 43' E & 33' N/O C/L INT	L 5350
NEWHALL (2009)	1,476.404 450.009	DPW BM TAG IN S CB VIA PRINCESSA (FR THE W) 1' W/O BCR 44' S/O C/L & 141' W/O C/L INT WHITES CYN RD	L 5352
NEWHALL (2009)	1,473.629 449.163	DPW BM TAG IN E CB VIA PRINCESSA (S) 49' S/O BCR 43' E/O C/L & 203' S/O C/L WHITES CYN RD	L 5353
NEWHALL (2009)	1,406.961 428.843	DPW BM TAG IN W CB WEYERHAEUSER WAY 6' N/O BCR 23' W/O C/L & 85' N/O C/L VIA PRINCESSA	L 5354
NEWHALL (2009)	1,238.166 377.394	DPW BM TAG E CB 2' N/O BCR @ NE COR BOUQUET CYN RD & CENTRAL PARK	L 5355

QUAD YEAR	ELEV FOOT/METER	DESCRIPTION	BM NUMBER
NEWHALL (2009)	1,176.146 358.490	DPW BM TAG IN E CB 9' N/O BCR @ NE COR BOUQUET CYN RD & NEWHALL RANCH RD 89' N & 60' E/O C/L INT	L 5356
NEWHALL (2009)	1,175.889 358.412	DPW BM TAG IN W CB 10' N/O BCR @ NW COR BOUQUET CYN RD & NEWHALL RANCH RD 85' N & 59' W/O C/L INT	L 5357
NEWHALL (2009)	1,164.344 354.893	DPW BM TAG IN N CB 46' W/O BCR @ NW COR BOUQUET CYN RD & VALENCIA BL 118' W & 47' N/O C/L INT	L 5358
NEWHALL (2009)	1,352.665 412.294	LACO BM TAG IN E CB 8' S/O BCR @ SE COR NEWHALL AVE & MEADOW RIDGE DR (N END C B)	L 5359
NEWHALL (2009)	1,433.450 436.917	LACO BM TAG IN W CB N END C B OPP #23222 SIERRA HWY ±¼ MI S/O NEWHALL AVE	L 5360
NEWHALL (2009)	1,791.509 546.054	LACO BM TAG IN NW COR 3'X3' CONC PAD 77' S/O C/L THE OLD RD & 33' E/O C/L WELDON CYN RD	L 5364
NEWHALL (2009)	1,490.630 454.345	LACO BM TAG IN SE COR 3'X3' CONC PAD 25' E/O C/L RD TO CRESCENT VALLEY TRAILER PARK #23500 & 75' N/O C/L THE OLD RD	L 5367
NEWHALL (2009)	1,431.557 436.340	LACO BM TAG IN NW COR CHANNEL HDWL 62' N/O C/L THE OLD RD & 0.9MI S/O CHIQUELLA LN @ MI MKR #13.80	L 5368
NEWHALL (2009)	1,362.380 415.255	LACO BM TAG IN SLY WINGWALL OF DRWY @ #24314 THE OLD RD 65' ELY OF C/L (CALGROVE KENNELS)	L 5369
NEWHALL (2009)	1,339.001 408.129	LACO BM TAG IN SE CB RET 10' N/O BCR 40' S/O C/L ON RAMP 5FRWY SO & 39' E/O C/L CALGROVE BL	L 5370
NEWHALL (2009)	1,343.060 409.366	LACO BM TAG IN S CB CALGROVE BLVD 3' W/O BCR 33' S/O C/L & 50' W/O C/L VALLEY OAK CT (WILEY CYN RD TO N)	L 5371
NEWHALL (2009)	1,309.436 399.117	LACO BM TAG IN N CB FOURL RD 3' E/O END OF CB 20' N/O C/L & 167' E/O C/L WILEY CYN RD	L 5372
NEWHALL (2009)	1,273.555 388.181	LACO BM TAG IN S CB 2' E/O BCR @ SE COR WILEY CYN RD & EVANS AVE	L 5373
NEWHALL (2009)	1,275.919 388.901	LACO BM TAG IN W CB TOURNAMENT RD 12' N/O BCR 25' W/O C/L & 79' N/O C/L WILEY CYN (N END C B)	L 5374
NEWHALL (2009)	1,276.714 389.144	LACO BM TAG IN W CB TOURNAMENT RD 28' N/O BCR @ NW COR 33' W C/L & 76' N/O C/L GOLF VIEW DR (N END C B)	L 5375
NEWHALL (2009)	1,304.043 397.474	LACO BM TAG IN E CB ROCKWELL CYN RD 33' E/O C/L & 1300' N/O MC BEAN PKWY (@ ST LT #2161925E)	L 5376
NEWHALL (2009)	1,054.284 321.347	LACO BM TAG IN W CB THE OLD RD 33' W/O C/L & 790' N/O SEDONA WAY (@ LT STD #4093805E)	L 5383
NEWHALL (2009)	1,077.096 328.300	CO ENG TAG IN E CB THE OLD RD 15' E/O C/L & 161' S/O C/L DIRT RD TO HSE #30225 (370' S/O W WEDGEWOOD CTR)	L 5384
NEWHALL (2009)	1,202.012 366.374	LACO BM TAG IN W CB 2' S/O BCR @ SW COR THE OLD RD & PARKER RD 70' S & 32' W/O C/L INT	L 5386
NEWHALL (2009)	1,476.739 450.111	LACO BM TAG IN N CB SOLEDAD CYN RD 45' N/O C/L & 530' W/O ENT TO CITY SANTA CLARITA CYN PARK	L 5387

QUAD YEAR	ELEV FOOT/METER	DESCRIPTION	BM NUMBER
NEWHALL (2009)	1,444.589 440.312	LACO BM TAG IN N CB 1' E/O BCR @ NE COR SOLEDAD CYN RD & SOLAMINT RD 56' E & 43' N/O C/L INT	L 5388
NEWHALL (2009)	1,369.907 417.549	LACO BM TAG W CB 2' N/O BCR @ NW COR SOLEDAD CYN RD & CAMP PLENTY RD	L 5389
NEWHALL (2009)	1,281.544 390.616	LACO BM TAG N CB 3' E/O BCR @ NE COR SOLEDAD CYN RD & RUETHER AVE 65' E & 43' N/O C/L INT (W END C B)	L 5391
NEWHALL (2009)	1,280.751 390.374	LACO BM TAG N CB 3' W/O BCR @ NW COR SOLEDAD CYN RD & RUETHER AVE 57' W & 43' N/O C/L INT	L 5392
NEWHALL (2009)	1,230.421 375.033	LACO BM TAG IN N CB 3' W/O BCR @ NW COR SOLEDAD CYN RD & GOLDEN OAK RD 59' W & 43' N C/L INT	L 5394
NEWHALL (2009)	1,192.435 363.455	LACO BM TAG IN SLY CB SOLEDAD CYN RD 43' S/O C/L & 5' E/O E END WLY DRWY TO SAUGUS RACEWAY PARKING LOT (0.25MI WLY OF COMMUTER WAY)	L 5395
NEWHALL (2009)	1,176.164 358.496	LACO BM TAG IN S CB @ 22840 SOLEDAD CYN RD 44' S/O C/L & 0.25MI E/O BOUQUET CYN RD (3' E/O PP #2124044E)	L 5396
NEWHALL (2009)	1,318.800 401.971	LACO BM TAG IN CONC APRON OF DRWY TO HSE #21366 PLACERITA CYN RD 16' S/O C/L & 69' E/O C/L DESERT AVE (1' W/O E EDGE)	L 5399
NEWHALL (2009)	1,337.104 407.551	LACO BM TAG @ SW COR OF 5'X5'M CONC SLAB FOR MAIL BOXES NR NW COR PLACERITA CYN RD & GOLDEN OAK LN (DIRT RD) 63' N & 26' W/O C/L INT	L 5400
NEWHALL (2009)	1,378.737 420.240	LACO BM TAG IN SW COR OF 6'X6' CONC EDISON VAULT 20' N/O C/L PLACERITA CYN RD & 0.3MI W/O SIERRA HWY (49' N/O PP #SC 46926)	L 5401
NEWHALL (2009)	1,031.831 314.503	RND HD SPK IN LOWER OF TWO CONC HDWLS @ N END 24' W/O C/L THE OLD RD (W RDWY) & 0.6MI S/O HENRY MAYO DR @ MI MKR #6.25	L 5402
NEWHALL (2009)	1,517.343 462.488	LACO BM TAG IN E CB SIERRA HWY 43' E/O C/L & 118' S/O C/L HILLFIELD LN	L 5403
NEWHALL (2009)	1,459.952 444.995	LACO BM TAG IN S CB 2' E/O BCR @ SE COR DOLAN WAY & SIERRA HWY 50' S & 34' E/O C/L INT	L 5404
NEWHALL (2009)	1,538.894 469.056	LACO BM TAG IN W CB SIERRA HWY, 0.5MI N/O PLACERITA CYN RD 3' N/O PP #4081403	L 5406
NEWHALL (2009)	1,499.204 456.959	LACO BM TAG IN N CB 3' W/O BCR @ NW COR SIERRA HWY & DOCKWEILER DR	L 5408
NEWHALL (2009)	1,603.289 488.684	LACO BM TAG E CB 8' N/O BCR @ NE COR WHITES CYN RD & WILDWIND RD	L 5411
NEWHALL (2009)	1,905.683 580.854	LACO BM TAG IN E WALL OF ROCK DRAIN 20' N/O C/L PLACERITA CYN RD & 1.7MI W/O RAVENHILL RD @ MM #5.27	L 5414
NEWHALL (2009)	1,575.879 480.329	LACO BM TAG IN E WALL ROCK DRAIN 20' S/O C/L PLACERITA CYN RD & 0.3MI W/O ENT TO PLACERITA CYN STATE PARK 150' SE/O PP (NO #) NR MM #3.35	L 5415

QUAD YEAR	ELEV FOOT/METER	DESCRIPTION	BM NUMBER
NEWHALL (2009)	1,600.695 487.893	L&BR IN ROCK WALL OF DRAIN 20' N/O C/L VASQUEZ CYN RD & 690' E/O LOST CREEK RD 47' E/O PP#1527340E	L 5419
NEWHALL (2009)	1,978.359 603.006	LACO BM TAG 5' E/O W END OF ROCK WALL OF DRAIN 20' N/O C/L VASQUEZ CYN RD & 0.55MI W/O BURTON WAY 40' N/O PP (#1527382E)	L 5420
NEWHALL (2009)	1,770.333 539.599	LACO BM TAG IN NW COR 5'X5' CONC MAIL BOX PAD (3' N/O MAIL BOX POST) 47' E & 7' N/O C/L INT VASQUEZ CYN RD & VASQUEZ WAY	L 5421
NEWHALL (2009)	1,721.822 524.813	L&T IN NLY HDWL OF ROCK BRIDGE 25' W/O C/L VASQUEZ CYN RD & 20' N/O C/L GASPE ST	L 5422
NEWHALL (2009)	1,723.540 525.337	NGS 4" BR DISC IN WALK @ SWLY COR OF BRIDGE 26' S/O C/L VASQUEZ CYN RD & 243' W/O C/L SIERRA HWY MKD (F 1470 1994)	L 5423
NEWHALL (2009)	1,701.458 518.606	FC 4" BR DISC IN N END HDWL 26' WLY C/L SIERRA HWY & 115' SLY OF GARYFORD RD @ MI MKR #44.37 MKD (BM 145-01710 1963)	L 5424
NEWHALL (2009)	1,197.712 365.064	CSBM MON E END C B 44' S/O C/L SOLEDAD CYN RD & 790' W/O COMMUTER WAY MKD (BM 201-120A 1976)	L 5425
NEWHALL (2009)	1,130.678 344.632	LACO BM TAG IN CONC F HYD PAD @ SE COR LINCOLN AVE & CHIQUITO CYN RD 46' E & 13' S/O C/L INT (@ NW COR PAD)	L 5432
NEWHALL (2009)	1,161.320 353.971	LACO BM TAG IN CONC F HYD PAD @ SW COR MADISON WAY & CHIQUITO CYN RD 25' S & 20' W/O C/L INT	L 5433
NEWHALL (2009)	1,283.383 391.176	LACO BM TAG IN CONC F HYD PAD 15' S C/L HASLEY CYN RD & 380' W/O C/L GALLOPING CT 59' E/O PP #835344H	L 5440
NEWHALL (2009)	1,331.315 405.786	LACO BM TAG IN SE COR OF CONC ELEC BOX PAD 33' N/O C/L HASLEY CYN RD & 233' W/O C/L SLOAN CYN RD 16' E/O PP #1024887H	L 5441
NEWHALL (2009)	1,439.611 438.795	LACO BM TAG IN SE COR OF CONC F HYD PAD 43' E/O C/L SLOAN CYN RD & 0.7MI N/O HASLEY CYN RD 15' S/O SLY P/L HSE #30414	L 5444
NEWHALL (2009)	1,166.770 355.633	LACO BM TAG IN W CB 49' N/O BCR @ NW COR BOUQUET CYN RD & MAGIC MTN PKWY 167' N & 50' W/O C/L INT @ ST LT	L 5445
NEWHALL (2009)	1,536.997 468.478	LACO BM TAG @ E END C.B. UNDER FRWY RAMP 20' S/O C/L THE OLD RD & 145' E/O C/L OFF RAMP 14FRWY S	L 6049
NEWHALL (2009)	1,549.853 472.397	LACO BM TAG IN S CB OF C/L MED 1' W/O BCR NR E END 5' S/O C/L THE OLD RD & 0.87MI NW/O WELDON CYN RD (7' W/O & S/O PP#4384444E)	L 6051
NEWHALL (2009)	1,323.084 403.277	RCE #10533 TAG IN WLY CB WILEY CYN RD 21' W/O C/L & 44' N/O C/L PROD CANERWELL ST	L 6052
NEWHALL (2009)	1,287.748 392.507	LACO BM TAG IN E CB 5' S/O BCR @ SE COR WILEY CYN RD & WABUSKA ST	L 6053
NEWHALL (2009)	1,548.235 471.903	LACO BM TAG IN CONC COLLAR BELL TELE MH E SIDE 36' E/O C/L SIERRA HWY & 150' S/O C/L REMSEN ST (E) (OPP NURSERY)	L 6054
NEWHALL (2009)	1,691.125 515.456	LA CO BM TAG IN CONC COLLAR BELL TELE MH E SIDE 30' E/O C/L SIERRA HWY 1970' S/O REMSEN ST (E) @ FENCE TO GAS FACILTY (20' N/O PP#1120)	L 6055

QUAD YEAR	ELEV FOOT/METER	DESCRIPTION	BM NUMBER
NEWHALL (2009)	1,697.479 517.393	L & SM SPK IN N END HDWL 38' E/O C/L SIERRA HWY & 0.7MI S/O REMSSEN ST E & 45' S/O PP#1865789E	L 6056
NEWHALL (2009)	1,489.691 454.059	LA CO BM TAG IN CONC HDWL N END 44' W/O C/L SIERRA HWY & 212' S/O M DRWY BLD #22117	L 6057
NEWHALL (2009)	1,213.735 369.948	LACO BM TAG IN S CB 3' W/O BCR @ SW COR ROCKWELL CYN RD & VALENCIA BL	L 6058
NEWHALL (2009)	1,186.069 361.515	RCE TAG #16913 IN S CB VALENCIA BL 69' S/O C/L @ C/L PROD TOURNEY RD	L 6059
NEWHALL (2009)	1,189.779 362.646	LACO BM TAG IN N CB 3' E/O BCR @ NE COR VALENCIA BL & TOURNEY RD	L 6060
NEWHALL (2009)	1,094.495 333.603	LACO BM TAG IN N CB 50' N/O C/L MAGIC MTN PKWY & 3' E/O C/L PROD TOURNEY RD	L 6061
NEWHALL (2009)	1,261.457 384.493	DPW TAG IN W CB 2' N/O BCR @ NW COR SAN FERNANDO RD & 12TH ST	L 6063
NEWHALL (2009)	1,261.582 384.531	LACO BM TAG IN E CB @ NE COR BRIDGE 53-2788 40' E/O C/L SAN FERNANDO RD & 154' N/O C/L 12TH ST	L 6064
NEWHALL (2009)	1,231.109 375.243	DPW TAG IN E CB 40' E/O C/L SAN FERNANDO RD @ C/L PROD 15TH ST	L 6065
NEWHALL (2009)	1,201.063 366.085	LACO BM TAG IN E CB @ S END C B 40' E/O C/L RAILROAD AVE & 102' S/O C/L BRIDGE 53-2890 (15' N/O LT STD 4486382E)	L 6066
NEWHALL (2009)	1,193.131 363.667	LACO BM TAG IN E CB 3' N/O BCR @ NE COR RAILROAD AVE & OAK RIDGE DR	L 6067
NEWHALL (2009)	1,166.504 355.551	SM SPK @ SW COR BRIDGE 53-15 OVER SANTA CLARA RIVER 46' S/O C/L MAGIC MTN PKY & 72' E/O C/L DRWY RD TO EDISON TOWER (TOP BRIDGE ABUT)	L 6068
NEWHALL (2009)	1,111.684 338.842	LACO BM TAG IN N CB @ F HYD 40' E/O E END BLDG 24805 & 63' N/O C/L MAGIC MTN PKY & 370'M E/O C/L FAIRWAYS DR (6' W/O LT STD #4449962E)	L 6069
NEWHALL (2009)	1,358.434 414.052	LACO BM TAG N CB OF ENT TO PLACERITA CYN 15' N/O C/L PLACERITA CYN RD & 69' W/O PP #102-72	L 6070
NEWHALL (2009)	1,291.517 393.656	LACO BM TAG IN SW COR DWY HSE #21925 26' W/O C/L DWY & 13' N/O PLACERITA CYN RD	L 6071
NEWHALL (2009)	1,280.968 390.440	LACO BM TAG IN SW COR CONC SLAB OF MAILBOXES @ SW COR. 57' S/O PLACERITA CYN RD & 27' W/O ADEN AV	L 6072
NEWHALL (2009)	1,200.780 365.999	LACO BM TAG IN E CB MCBEAN PKWY 39' E/O C/L & 50' S/O C/L GRANARY SQR, SE COR , 1.5' S/O BCR	L 6075
NEWHALL (2009)	1,151.860 351.088	LACO BM TAG IN E CB 3' S/O BCR @ SE COR MCBEAN PKWY & VALENCIA BL 102' S/O & 72' E/O C/L INT	L 6076
NEWHALL (2009)	1,146.896 349.575	LACO BM TAG IN N CB 3' W/O BCR @ NW COR VALENCIA BL & CITRUS ST	L 6077

QUAD YEAR	ELEV FOOT/METER	DESCRIPTION	BM NUMBER
NEWHALL (2009)	1,182.083 360.300	LACO BM TAG IN WLY CB VALENCIA BL 3' S/O BCR @ SW COR 65' W/O C/L & 85' S/O C/L GOLDCREST DR	L 6078
NEWHALL (2009)	1,019.985 310.892	LACO BM TAG IN ELY CB THE OLD ROAD 53' E/O C/L @ LT STD #5693 & 400' S/O TURNBERRY LANE	L 6082
NEWHALL (2009)	1,024.710 312.333	LACO BM TAG IN ELY CB THE OLD ROAD 43' E/O C/L NR C/L PROD MUIRFIELD LN @ N END C.B.	L 6083
NEWHALL (2009)	1,086.768 331.248	RCE #13695 TAG IN N CB 1' W/O BCR @ NW COR THE OLD ROAD & HILLCREST PKWY	L 6085
NEWHALL (2009)	1,243.563 379.039	LACO BM TAG IN N CB 2' W/O W END C.B. @ NE COR VALENCIA BL & THE OLD RD 63' N & 213' E/O C/L INT	L 6088
NEWHALL (2009)	1,208.896 368.473	LACO BM TAG IN E CB @ LT STD #4448368E 54' E/O C/L THE OLD RD & 50' S/O C/L N'LY DRWY BLDG# 26960 (1600' N/O C/L VALENCIA BL)	L 6089
NEWHALL (2009)	1,149.731 350.439	LACO BM TAG IN E CB @ N END C.B. 10' S/O LT STD #4417518E 49' E/O C/L THE OLD RD & 118' S/O & OPP DRWY @ N END OF BROWN BLOCK WALL (0.6MI N/O CL VALENCIA BL)	L 6090
NEWHALL (2009)	1,109.569 338.198	LACO BM TAG IN S CB 1' W/O BCR @ SW COR HASLEY CYN RD & COMMERCE CTR DR 33' S & 79' W/O C/L INT	L 6093
NEWHALL (2009)	1,149.102 350.247	LACO BM TAG IN N CB 33' N/O C/L HASLEY CYN RD @ LT STD #4215069E (0.3MI W/O COMMERCE CTR DR)	L 6094
NEWHALL (2009)	1,191.176 363.072	LACO BM TAG IN N CB 3' W/O BCR @ NW COR HASLEY CYN RD & GIBRALTAR LN 50' W & 33' N/O C/L INT	L 6095
NEWHALL (2009)	1,210.210 368.873	LACO BM TAG IN N CB 33' N/O C/L HASLEY CYN RD @ LT STD #4444855E (0.3MI W/O GIBRALTAR LN)	L 6096
NEWHALL (2009)	1,261.316 384.450	LACO BM TAG IN CONC CROSS GUTTER SE COR 16' S/O C/L HASLEY CYN RD & 46' E/O C/L TROTTERS LN	L 6097
NEWHALL (2009)	1,326.656 404.366	2" IP W/CONC PLUG SPK & LA CO W (FL) @ SE COR CORRAL @ NW COR HASLEY CYN RD 54' N/O C/L & 37' W/O C/L SLOAN CYN RD	L 6098
NEWHALL (2009)	1,506.451 459.168	LACO BM TAG IN SE COR CONC F HYD PAD 20' S/O HASLEY CYN RD & 32' W/O C/L DRWY HSE #30578 (7' W/O MM #4.21)	L 6099
NEWHALL (2009)	1,470.222 448.125	LACO BM TAG IN E CB @ BCR @ SE COR SLOAN CYN RD & VILLA CYN RD	L 6100
NEWHALL (2009)	1,196.402 364.664	L&BN IN SE COR CONC PAD F HYD @ SW COR OF CHIQUITO CYN RD & HUNSTOCK ST 23' S & 30' W/O C/L INT	L 6102
NEWHALL (2009)	1,183.441 360.714	CS PUNCHED HEX BAR MON IN WELL DN 1.5' @ C/L INT SAN MARTINEZ RD & CHIQUITO CYN RD	L 6103
NEWHALL (2009)	1,083.207 330.162	2" IP FL W/CONC PLUG & SPK & LACO W 1.5'I S/O PP#1882937E 28' W/O C/L CHIQUITO CYN RD & 0.3MI S/O LINCOLN AVE (290' S/O MM #0.87)	L 6104
NEWHALL (2009)	970.748 295.885	2" IP W/CONC PLUG SPK & LACO W FL 4' E/O W END G-RAIL 47' SLY/O C/L HENRY MAYO DR (HWY126) 0.3MI E/O CHIQUITO CYN RD	L 6105

QUAD YEAR	ELEV FOOT/METER	DESCRIPTION	BM NUMBER
NEWHALL (2009)	982.867 299.579	LACO BM TAG IN CTR NOSE OF C/L MED S END C/L CHIQUITO CYN LANDFILL ENT 89' N/O C/L HENRY MAYO DR (HWY126) 0.6MI E/O CHIQUITO CYN RD	L 6106
NEWHALL (2009)	956.937 291.675	LACO BM TAG IN CONC BASE ELEC VOLT BOX @ SW COR HENRY MAYO DR (HWY126) & WOLCOTT WAY 89' S & 20' W/O C/L INT (@ NE COR BASE)	L 6107
NEWHALL (2009)	957.286 291.782	LACO BM TAG IN CTR HDWL @ NE COR HENRY MAYO DR (HWY126) & WOLCOTT WAY 56' N & 106' E/O C/L INT	L 6108
NEWHALL (2009)	987.490 300.988	LACO BM TAG IN CB @ N END C/L MED @ ENT VALENCIA TRAVEL VILLAGE 256' S/O C/L HENRY MAYO DR (HWY126)	L 6109
NEWHALL (2009)	1,002.199 305.471	LACO BM TAG IN N CB 3' E/O BCR @ NW COR HENRY MAYO DR (HWY126) & COMMERCE CTR DR 89' W & 43' N/O C/L INT	L 6110
NEWHALL (2009)	1,160.999 353.874	L&T IN E CB 1' S/O BCR @ SE COR RIDGE RTE & VIOLIN CYN RD 46' S & 33' E/O C/L INT	L 6111
NEWHALL (2009)	1,153.684 351.644	SPK & W#DS-3 IN SE COR BRIDGE #B-1552 16' S/O C/L LAKE HUGHES RD & 0.30MI E/O RIDGE RTE	L 6112
NEWHALL (2009)	1,566.739 477.543	LA CO RD DEPT MON IN WELL ON C/L LAKE HUGHES RD 112' N/O MI MRK #21.46	L 6113
NEWHALL (2009)	1,758.563 536.012	2" IP W/CONC PLUG SPK & LACO DPW W FL 43' E/O C/L LAKE HUGHES RD & 2' E/O MI MRK #20.91	L 6114
NEWHALL (2009)	2,029.556 618.611	2" IP W/CONC PLUG SPK & LACO DPW W FL 33' E/O C/L LAKE HUGHES RD & 367' N/O MI MRK #20.04 (3' E/O N END GUARD RAIL NR CALL BOX LH198)	L 6116
NEWHALL (2009)	1,957.807 596.741	LACO BM TAG IN HDWL (3' N/O S END) 26' W/O C/L LAKE HUGHES RD & 102' S/O MI MRK #19.61	L 6117
NEWHALL (2009)	1,933.077 589.204	LACO BM TAG IN WING WALL 3' S/O N END 28' E/O C/L LAKE HUGHES RD & 26' N/O MI MRK #19.46	L 6118
NEWHALL (2009)	1,961.069 597.736	LACO BM TAG IN WING WALL 3' S/O N END & 26' E/O C/L LAKE HUGHES RD & 26' N/O MI MRK #18.95	L 6119
NEWHALL (2009)	2,041.077 622.122	LACO BM TAG IN NE COR CONC PAD 43' E/O C/L LAKE HUGHES RD @ DRY GULCH RD (DIRT) 80' S/O C/L MON #4650 & 105' S/O MI MRK #16.30	L 6120
NEWHALL (2009)	1,534.285 467.651	LACO BM TAG IN WINGWALL 4' S/O SW COR BRIDGE #2485 13' W/O C/L SAN FRANCISQUITO CYN RD 0.38MI S/O POWER HSE #2 (2.2MI N/O ANGELES FOREST BNDRY SIGN)	L 6124
NEWHALL (2009)	1,342.048 409.057	2" IP W/SPK & W FL ON PROD P POLE LINE TO W & 46' W/O C/L SAN FRANCISQUITO CYN RD 34' S/O C/L QUAILTRAIL (PVT) (TO W) @ MAIL BOX CLUSTER 3' SE/O TELE CABLE BOX 2' HIGH	L 6126
NEWHALL (2009)	1,300.488 396.390	2" IP W/SPK & W FL 2' E/O PP#1021498H & 2' W/O TELE CABLE BOX 2.6' HIGH @ SE COR SAN FRANCISQUITO CYN RD & SHAWNEE CT 26' E/O C/L & 40' S/O C/L INT	L 6127

QUAD YEAR	ELEV FOOT/METER	DESCRIPTION	BM NUMBER
NEWHALL (2009)	1,284.282 391.450	LACO BM TAG IN E CB 1' N/O BCR @ SE COR SAN FRANCISQUITO CYN RD & LOWRIDGE PL 38' S & 30' E/O C/L INT	L 6128
NEWHALL (2009)	1,308.631 398.872	LACO BM TAG @ NW COR CONC BASE ELEC TRAFFIC SIGN BOARD #28420 23' E/O C/L SAN FRANCISQUITO CYN RD & 0.22MI N/O COPPER HILL DR (NR BC OF CURVE) 23' N/O PP#4256078E (76' S/O C/L DR) HSE#28440)	L 6130
NEWHALL (2009)	1,371.205 417.945	L&T IN S CB 4' E/O BCR @ SE COR COPPER HILL DR & NORTHPARK DR	L 6131
NEWHALL (2009)	1,371.226 417.951	L&T IN N CB 5' E/O BCR @ NE COR COPPER HILL DR & SAN FRANCISQUITO CYN RD 50' N & 43' E/O C/L INT	L 6132
NEWHALL (2009)	1,372.619 418.376	L&BRAD IN N CB 1' W/O BCR @ NE COR COPPER HILL DR & SYCAMORE CREEK DR 65' W & 54' N/O C/L INT	L 6133
NEWHALL (2009)	1,342.593 409.224	LACO BM TAG IN S CB 3' W/O BCR @ SW COR SECO CYN RD & COPPER HILL DR 54' S & 79' W/O C/L INT	L 6134
NEWHALL (2009)	1,492.573 454.938	LACO BM TAG IN N CB 1' E/O BCR @ NE COR COPPER HILL DR & PARAGON DR (NR W END C.B.)	L 6135
NEWHALL (2009)	1,262.852 384.918	LA CO BM TAG IN W CB SECO CYN RD 33' W/O C/L & 33' S/O C/L PROD GUADILAMAR DR	L 6136
NEWHALL (2009)	1,324.520 403.715	LACO BM TAG IN E CB 3' S/O BCR @ SE COR BOUQUET CYN RD & WELLSTON DR	L 6137
NEWHALL (2009)	1,535.162 467.919	DPW BM TAG E CB @ BCR @ NE COR PLUM CYN RD & SANTA CATARINA RD	L 6139
NEWHALL (2009)	1,605.484 489.353	DPW BM TAG S CB @ BCR @ SE COR PLUM CYN RD & HELLER CIR (W)	L 6140
NEWHALL (2009)	1,643.997 501.092	DPW BM TAG E CB 15' N/O BCR @ NE COR PLUM CYN RD & HELLER CIR (E)	L 6142
NEWHALL (2009)	1,644.062 501.112	DPW BM TAG E CB 3' S/O BCR @ SE COR PLUM CYN RD & HELLER CIR (E)	L 6143
NEWHALL (2009)	1,728.207 526.759	DPW BM TAG E CB @ BCR OF FUTURE DRWY @ NE COR 43' E/O C/L PLUM CYN RD & 0.2MI N/O C/L ASHBORO DR	L 6144
NEWHALL (2009)	1,742.374 531.077	DPW BM TAG W CB SIERRA HWY 1' S/O BCR @ SW COR GOLDEN VALLEY RD	L 6145
NEWHALL (2009)	1,456.673 443.995	L&BN N CB 1' W/O BCR @NW COR SIERRA HWY & VIA PRINCESSA	L 6147
NEWHALL (2009)	1,484.630 452.517	RCE #17532 TAG E CB @ BCR @ SE COR VIA PRINCESSA & MAY WAY	L 6148
NEWHALL (2009)	1,823.057 555.669	L&T @ W END ROCK HDWL 18' S/O C/L VASQUEZ CYN RD & 110' W/O C/L BURTON WAY (PVT) & 76' W/O MI MRK 2.66	L 6149
NEWHALL (2009)	1,855.305 565.499	LA CO BM TAG IN N END OF ELY ROCK WALL OF CULV 18' S/O C/L VASQUEZ CYN RD & 10' W/O C/L DRWY HSE #16703 79' W/O PP#1527392E (0.25MI N/O BURTON WAY)	L 6150

QUAD YEAR	ELEV FOOT/METER	DESCRIPTION	BM NUMBER
NEWHALL (2009)	1,538.927 469.066	LACO BM TAG IN E CB NR BCR NE COR SAND CYN RD & LOST CYN RD 16' E/O & 100' N/O C/L INT	L 6151
NEWHALL (2009)	1,542.554 470.172	LACO BM TAG IN W CB SAND CYN RD @ SPRR RAILROAD BRIDGE 530' S/O LOST CYN RD	L 6152
NEWHALL (2009)	1,977.371 602.704	DPW TAG IN W WING WALL @ S END CONC & ROCK DRAIN 20' N/O C/L PLACERITA CYN RD & 0.9MI W/O RAVENHILL RD NR MM 6.16	L 6155
NEWHALL (2009)	1,677.075 511.174	LACO BM TAG IN N CB 3' E/O BCR @ NE COR SOLEDAD CYN RD & POPPY MEADOW ST 45' N & 49' E/O C/L INT	L 6156
NEWHALL (2009)	1,666.371 507.911	LACO BM TAG IN N CB 7' W/O BCR @ NW COR SOLEDAD CYN RD & RAQUEL LANE	L 6157
NEWHALL (2009)	1,666.790 508.039	DPW TAG IN S CB SOLEDAD CYN RD 44' S/O C/L & 20' W/O C/L PROD SHADOW PINES BL	L 6158
NEWHALL (2009)	1,684.713 513.502	LACO BM TAG IN S CB 3' W/O BCR @ SWLY COR SOLEDAD CYN RD & ON RAMP 14 FRWY S BOUND 62' W & 49' S/O C/L INT (N SIDE 14 FRWY)	L 6159
NEWHALL (2009)	1,897.380 578.323	LA CO BM TAG IN N END WINGWALL N/O NE COR BRIDGE #3748 23' E/O C/L SIERRA HWY & 312' S/O C/L DRWY ENT TO RANCH #15142	L 6160
NEWHALL (2009)	1,937.232 590.470	DPW TAG IN S END HDWL 26' E/O C/L SIERRA HWY & 200' N/O C/L WRIGHT RD (PVT)	L 6161
NEWHALL (2009)	1,967.891 599.815	LACO BM TAG IN N END HDWL 38' E/O C/L SIERRA HWY & 103' S/O C/L DAVENPORT RD @ MI MRK 41.33	L 6162
NEWHALL (2009)	2,090.227 637.103	LACO BM TAG IN W END OF ANGELES NAT'L FOREST SIGN (CONC & ROCK) TO ROWHER FLATS O.H.V AREA 30' E/O C/L SIERRA HWY & 23' S/O C/L PROD ROAD TO ROWHER FLATS	L 6163
NEWHALL (2009)	2,180.511 664.622	LACO BM TAG IN LRG ROCK OVER DRAIN UNDER ROAD 28' N/O C/L SIERRA HWY & 25' W/O MI MRK 39.20	L 6164
NEWHALL (2009)	2,421.254 738.000	LA CO BM TAG IN CTR HDWL 31' S/O C/L SIERRA HWY & 210' E/O E MOST ENT TO MOTEL @ #12117 @ MI MRK 37.67	L 6166
NEWHALL (2009)	2,476.928 754.970	LACO BM TAG IN CTR OF HDWL 20' S/O C/L SIERRA HWY & 328' E/O ENT TO OLD MINT CYN RD @ MI MRK 37.27	L 6167
NEWHALL (2009)	2,724.649 830.476	2" IP W/LA CO PW WASH & SPK 57' N/O C/L SIERRA HWY & 72' W/O C/L PROD AQUA DULCE CYN RD 8' NW/O PP#2212146E & 4' W/O SW PROP COR FENCE OF HSE#10439	L 6168
NEWHALL (2009)	2,696.009 821.746	LACO BM TAG IN SE COR CONC SLAB FOR ELEC CONT BOX #PG-08 18' W/O C/L AGUA DULCE CYN RD & 50' S/O C/L DOORS OF CHURCH @ #34709	L 6169
NEWHALL (2009)	2,627.841 800.968	LACO BM TAG IN CONC RUNNER (3' S/O N END) FOR GATE @ #34363 AGUA DULCE CYN RD 77' W/O C/L & 26' W/O C/L INT SIERRA PELONA RD (PVT) & DRWY	L 6170
NEWHALL (2009)	2,532.443 771.891	LACO BM TAG IN E CB (@ LT STD) @ SE COR AGUA DULCE CYN RD & DARLING RD 92' S & 33' E/O C/L INT	L 6171

QUAD YEAR	ELEV FOOT/METER	DESCRIPTION	BM NUMBER
NEWHALL (2009)	2,237.121 681.877	CS BM MON FL 5' N/O PP#1848314E 25' N/O C/L DAVENPORT RD & 225' E/O MI MRK #1.70 MKD (BM 207-5A 1973 RE7078)	L 6173
NEWHALL (2009)	2,295.262 699.598	LACO BM TAG IN SW COR CONC BASE ELEC UTILITY BOX 39' E/O C/L DRWY HSE #13467 DAVENPORT RD & 25' N/O C/L & 187' W/O C/L CALLE VISTA (PVT)	L 6174
NEWHALL (2009)	2,324.422 708.486	RD BM TAG @ S END OF E HDWL CULV 23' E/O C/L SIERRA HWY & 72' S/O C/L DIRT RD (TO E) @ MI MRK 38.45	L 6175
NEWHALL (2009)	2,337.734 712.543	LACO BM TAG @ S END OF CONC RET WALL 20' E/O C/L AQUA DULCE CYN RD & 279' S/O C/L CAMINO DE SOL (PVT) (TO WEST)	L 6176
NEWHALL (2009)	2,161.172 658.727	LACO BM TAG IN SW COR BRIDGE #1459 ABUTMENT 18' W/O C/L AQUA DULCE CYN RD	L 6177
NEWHALL (2009)	2,059.690 627.795	LACO BM TAG IN CONC BASE OF 2ND POST FR S MOST END GUARD RAIL 18' E/O C/L AQUA DULCE CYN RD & 33' S/O SE BRIDGE ABUTMENT	L 6178
NEWHALL (2009)	2,804.459 854.802	LA CO BM TAG IN W END CONC HDWL 38' S/O C/L SIERRA HWY @ MI MRK #34.74 138' W/O C/L DRWY (DIRT) HSE#9342	L 6183
NEWHALL (2009)	2,805.317 855.063	LA CO BM TAG IN W END OF CONC HDWL 36' N/O C/L SIERRA HWY @ MI MRK #34.74 138' W/O C/L DRWY (DIRT) HSE#9342	L 6184
NEWHALL (2009)	3,213.947 979.614	LA CO BM TAG IN W (CONC) WINGWALL @ N END 162' E/O THOMAS RD (PVT) & 30' N/O C/L SIERRA HWY @ MI MRK #32.37	L 6186
NEWHALL (2009)	3,137.112 956.195	LA CO BM TAG @ W END CONC HDWL 35' N/O C/L SIERRA HWY @ MI MRK #30.27 (0.30MI N/O 14 FRWY)	L 6187
NEWHALL (2009)	2,998.006 913.795	LA CO BM TAG IN W END OF HDWL 30' N/O C/L SIERRA HWY & 124' W/O RED ROVER MINE RD	L 6189
NEWHALL (2009)	3,000.368 914.515	L & T @ SW COR CONC PAD ELEC PANEL BOX @ NE COR SIERRA HWY & RED ROVER MINE RD 44' N & 37' E/O C/L INT	L 6190
NEWHALL (2009)	2,953.783 900.316	L & T IN CTR HDWL 24' N/O C/L SIERRA HWY @ MI MRK #28.28 (0.20MI W/O CROWN VALLEY RD)	L 6191
NEWHALL (2009)	2,241.988 683.360	LACO BM TAG IN C/L OF CONC & ROCK HDWL 18' S/O C/L SOLEDAD CYN RD @ MI MRK #17.50	L 6192
NEWHALL (2009)	2,298.808 700.679	L&T IN CONC HDWL @ W END 26' S/O C/L SOLEDAD CYN RD @ MI MRK #18.46	L 6193
NEWHALL (2009)	2,466.854 751.899	LA CO BM TAG IN W END HDWL 27' S/O C/L SOLEDAD CYN RD @ MI MRK #20.27	L 6195
NEWHALL (2009)	2,564.509 781.665	LA CO BM TAG IN CONC APRON RR XING 1' W/O W RAIL 89' E/O C/L SOLEDAD CYN RD & 20' N/O C/L ENT TO #4700 (THOUSAND TRAILS CAMP GRND)	L 6196
NEWHALL (2009)	2,620.017 798.584	LA CO DPW BM TAG @ NE COR COR CONC BASE TELE BOX 120' NE/O & 30' S/O C/L INT CROWN VALLEY RD & ARRASTRE CYN RD	L 6198

QUAD YEAR	ELEV FOOT/METER	DESCRIPTION	BM NUMBER
NEWHALL (2009)	1,444.898 440.406	L&LA CO DPW TAG IN S. CURB, 3' E/O BCR @ SE COR PICO CYN RD & WHISPERING OAKS RD	L 7050
NEWHALL (2009)	1,433.726 437.001	L&LA CO DPW TAG IN S. CURB, 1' W/O BCR @ SW COR PICO CYN RD & SOUTHERN OAKS DR	L 7051
NEWHALL (2009)	1,397.023 425.814	L&LA CO DPW TAG IN N. CURB, 25' W/O BCR @ NW COR PICO CYN RD & STEVENS RANCH PKWY	L 7052
NEWHALL (2009)	1,351.800 412.030	L&T IN N. CURB @ BCR , NW COR PICO CYN RD & CONSTITUTION AVE	L 7053
NEWHALL (2009)	1,329.124 405.118	L&LA CO DPW TAG IN S. CURB, 8' W/O BCR @ SE COR PICO CYN RD & 'THE OLD ROAD'	L 7054
NEWHALL (2009)	1,348.352 410.979	L&LA CO DPW TAG IN S. WALK, 1' S/O CURB FACE, 85' E/O BCR N. BOUND OFFRAMP 5 FRWY & LYONS AVE, 7.5' E/O HISTORICAL LANDMARK PLACARD #172	L 7055
NEWHALL (2009)	1,321.446 402.778	L&SM MAG NAIL IN N CB 1' W/O BCR @ NE COR WILEY CYN RD & CANERWELL ST	L 7056
NEWHALL (2009)	1,348.670 411.076	L&LA CO. DPW TAG IN W. CURB 'THE OLD ROAD', 92' S/O C.B., AND ±¼ MILE N/O STEVENSON RANCH RD	L 7057
NEWHALL (2009)	1,295.748 394.945	L&LA CO. DPW TAG IN W. CURB 'THE OLD ROAD', 6' S/O F.H., AND ±½MILE N/O STEVENSON RANCH RD	L 7058
NEWHALL (2009)	1,273.551 388.180	L&LA CO. DPW TAG IN W. CURB 'THE OLD ROAD', ±140' S/O TWIN OAKS PL	L 7059
NEWHALL (2009)	1,402.859 427.593	L&LA CO. DPW TAG IN SE. COR STEVENSON RANCH PKWY & 'THE OLD ROAD', 1' E/O BCR	L 7060
NEWHALL (2009)	1,342.733 409.266	L&LA CO. DPW TAG IN SE. COR 'THE OLD ROAD' & MARKET CENTER, ±4' S/O FH	L 7061
NEWHALL (2009)	1,340.313 408.529	L&BRAD SE COR EDISON VAULT (5'X5'), 20' E/O CL 'THE OLD ROAD' & 600' N/O CALGROVE BL	L 7062
NEWHALL (2009)	1,327.787 404.711	L&BRAD NE COR. AT&T CABLE BOX, 21' W/O CL 'THE OLD ROAD' & ±½ MILE S/O SAGECREST CIR	L 7063
NEWHALL (2009)	1,324.825 403.808	L&LA CO DPW TAG E.CURB 'THE OLD ROAD' & ±¼ MILE S/O SAGECREST CIR, 180' N/O MM 12.27	L 7064
NEWHALL (2009)	1,313.975 400.501	L&LA CO DPW TAG E.CURB 'THE OLD ROAD' @ SAGECREST CIR, 10' S/O CL PROD	L 7065
NEWHALL (2009)	1,345.971 410.253	L&LA CO DPW TAG N.CURB 'THE OLD ROAD' @ CHIQUELLA LN, 1' W/O CL BCR	L 7066
NEWHALL (2009)	1,405.073 428.268	L&LA CO DPW TAG W. CURB STEVENSON RANCH PKWY, N/O POE PKWY @ N'LY COR C.B.	L 7067
NEWHALL (2009)	1,405.230 428.315	L&LA CO DPW TAG E. CURB STEVENSON RANCH PKWY, 14' N/O CL PROD HEMINGWAY AVE, N.END OF C.B.	L 7068

QUAD YEAR	ELEV FOOT/METER	DESCRIPTION	BM NUMBER
NEWHALL (2009)	1,111.403 338.757	L&DPW TAG N. END OF C.B., OPP. BLDG# 27430 'THE OLD ROAD', ±¼ MILE S/O MAGIC MTN PKWY	L 7069
NEWHALL (2009)	1,094.774 333.688	L&LA CO DPW TAG, SE COR 'THE OLD ROAD' & MAGIC MTN PKWY, @NE END OF WHEEL CHAIR RAMP	L 7070
NEWHALL (2009)	1,093.805 333.393	L&LA CO DPW TAG, NW COR 'THE OLD ROAD' & MAGIC MTN PKWY, @SW END OF WHEEL CHAIR RAMP	L 7071
NEWHALL (2009)	1,263.604 385.148	L&LA CO DPW TAG IN W. CURB RAILROAD AVE, 80' S/O CL LYONS AVE, N'LY END OF C.B.	L 7072
NEWHALL (2009)	1,506.112 459.064	L&LA CO DPW TAG IN N. CURB, 5' W/O BCR @ NW COR HEMINGWAY AVE & LONDON PLACE	L 7073
NEWHALL (2009)	1,260.472 384.193	LA CO DPW TAG, NW COR SOLEDAD CYN RD & VALLEY CTR RD, 1' W/O BCR	L 7074
NEWHALL (2009)	1,675.632 510.734	L&LA CO DPW TAG IN S. CURB, SW COR KAVENAGH LN & CARROLL LN, 2' W/O BCR	L 7075
NEWHALL (2009)	1,740.989 530.655	L&LA CO DPW TAG W. CURB, SW COR MALLORY DR & WAYCOTT WAY, 4' S/O BCR	L 7076
NEWHALL (2009)	1,747.636 532.681	L&LA CO DPW TAG W. CURB, NW COR MALLORY DR & POE PKWY, 8' N/O BCR	L 7077
NEWHALL (2009)	1,622.952 494.677	L&LA CO DPW TAG S. CURB, SE COR POE PKWY & BROOKS CIR (E'LY), 8' E/O BCR	L 7078
NEWHALL (2009)	1,537.981 468.778	L&LA CO DPW TAG N. CURB, NE COR POE PKWY & HEMINGWAY AVE, 5' E/O BCR	L 7079
NEWHALL (2009)	1,073.955 327.342	LA CO DPW TAG 2' S/O S'LY CURB & 3' E/O W'LY EDGE OF CONC @ SW'LY BRIDGE ABUT - HASLEY CYN RD OVER I-5 (9' NW'LY END OF WING WALL ABUT)	L 7080
NEWHALL (2009)	1,434.014 437.089	L&LA CO DPW TAG NE COR VALENCIA BLVD & OLD ROCK RD, 1' E/O BCR	L 7081
NEWHALL (2009)	1,353.102 412.427	L&LA CO DPW TAG S. CURB, SW COR VALENCIA BLVD & HARITAGE VIEW DR, W. END OF C.B.	L 7082
NEWHALL (2009)	1,073.433 327.183	LA CO DPW TAG IN W.CURB NORTH BOUND LANE OF RUNABOUT @ HASLEY CYN RD & 'THE OLD RD'	L 7083
NEWHALL (2009)	1,051.894 320.618	LA CO DPW TAG NE COR 'THE OLD RD' & SEDONA WAY, 10' S/O BCR	L 7084
NEWHALL (2009)	1,058.666 322.682	LA CO DPW TAG SW COR HASELY CYN RD & CAMBRIDGE AVE, 2' W/O BCR	L 7085
NEWHALL (2009)	1,025.103 312.452	LA CO DPW TAG COR POST FTG, 22' N/O MM 1.37 ON CHIQUETO CYN RD (S'LY EDGE OF LA CO FD DRWY)	L 7086
NEWHALL (2009)	1,299.415 396.063	LA CO DPW TAG S'LY SIDE DEL VALLE RD & 0.75MI S/O HASLEY CYN RD, SW COR FH PAD (35' N/O PP#4388308E)	L 7087

QUAD YEAR	ELEV FOOT/METER	DESCRIPTION	BM NUMBER
NEWHALL (2009)	1,247.754 380.317	LA CO DPW TAG S/SIDE DEL VALLE RD, 0.25 MI SW HASLEY CYN RD, N'LY COR FH PAD (50' NE PP#4388323E)	L 7088
NEWHALL (2009)	1,215.726 370.554	LA CO DPW TAG 210' SW CL INT HASLEY CYN RD & DEL VALLE RD, N. COR BUS PAD # 11043	L 7089
NEWHALL (2009)	1,210.139 368.851	LA CO DPW TAG N. COR CONC DR. 70' S/O FH, NEAR CL INT HASLEY CYN RD & DEL VALLE RD (30' S/O ENT HASLEY CYN TRAIL)	L 7090
NEWHALL (2009)	1,514.884 461.738	L&T IN TC, 3' W/O BCR, SE COR HILLCREST PKWY & CAPALLERO DR. (@ST LT. #4384003E)	L 7091
NEWHALL (2009)	1,517.470 462.526	L&BRAD, 1' E/O BCR, SE COR HILLCREST PKWY & BARCELONA RD	L 7092
NEWHALL (2009)	1,450.041 441.974	L&BRAD, S'LY CURB HILLCREST PKWY @ CL PROD APPALANCHIAN DR.	L 7093
NEWHALL (2009)	1,369.113 417.307	L&BRAD, 1' E/O BCR, SE COR HILLCREST PKWY & BERYL PL	L 7094
NEWHALL (2009)	1,309.957 399.276	L&BRAD, 22' E/O BCR, NE COR HILLCREST PKWY & PARK VISTA DR	L 7095
NEWHALL (2009)	1,227.581 374.168	L& RCE TAG #13095, 2' E/O BCR, SE COR HILLCREST PKWY & YOSEMITE DR	L 7096
NEWHALL (2009)	1,139.732 347.391	L& RCE TAG #13095, SE COR HILLCREST PKWY & OLYMPIC ST, @ BCR,	L 7097
NEWHALL (2009)	1,409.149 429.510	LA CO DPW TAG, ROMERO CYN RD OVER HASLEY CRK, SE COR BRIDGE #3334, 190' N/O HASLEY CYN RD	L 7098
NEWHALL (2009)	1,453.395 442.996	L&BRAD IN CONC GUTTER, SW COR HASLEY CYN RD & VALLEY GLEN CT	L 7099
NEWHALL (2009)	1,600.298 487.772	LA CO ENG'R TAG SE COR CONC SLAB, W/END OF HASLEY CYN RD, 1.8MI W/O SLOAN CYN RD, 12' E/O PP#726066E	L 7100
NEWHALL (2009)	1,199.529 365.618	LA CO DPW TAG, 35' E/O BCR, SE COR 'THE OLD ROAD' & PARKER RD, NW COR BUS PAD	L 7101
NEWHALL (2009)	1,160.660 353.770	L&BRAD E. CURB 'THE OLD ROAD' & 0.25MI S/O PARKER RD, 25, S/O CL BC, (250' N/O MM1.95)	L 7102
NEWHALL (2009)	1,023.585 311.990	LA CO DPW TAG IN CB, 2' N/O SE BCR @ NOSE OF MEDIAN, OPP N;LY DRWY BLDG# 24648 'THE OLD ROAD' (C.H.P. BLDG)	L 7103
NEWHALL (2009)	1,047.766 319.360	LA CO DPW TAG IN CONC BASE PP#4244763E, 13' W/O CL 'THE OLD ROAD & 0.3MI N/O RYE CYN RD	L 7104
NEWHALL (2009)	1,286.045 391.988	DPW TAG NR BCR @ SE COR OF (E SERV RD) SECO CYN RD & PAMPLICO DR 45' S & 18' E/O C/L INT MKD (BM EV 9)	L 7105
NEWHALL (2009)	1,043.680 318.115	CO ENG'R MON TOP OF HEADWALL @ S'LY END CL MEDIAN 'THE OLD ROAD & 0.4MI N/O RYE CYN RD, MRK'D BM 208-82-1968	L 7106
NEWHALL (2009)	1,351.952 412.076	PK NAIL IN S. CURB SOLEDAD RD, 0.3MI W/O CAMP PLENTY RD (9' E/O PP#4249625E)	L 7107

QUAD YEAR	ELEV FOOT/METER	DESCRIPTION	BM NUMBER
NEWHALL (2009)	1,103.647 336.393	SPK IN W'LY CURB CL MEDIAN COMMERCE CTR DR @ S.END OF BRIDGE OVER HASLEY CRK, 160' S/O S'LY DRWY BLDG# 29120	L 7108
NEWHALL (2009)	1,047.530 319.288	L&BRAD SW CURB COMMERCE CTR DR, S'LY COR HARRISON PKWY, 1' S/O BCR @ LT STD#4777305E	L 7109
NEWHALL (2009)	1,081.015 329.494	LA CO BM BR DISK MRK'D 7110, IN W.CURB COMMERCE CTR DR, 0.2MI N/O HARRISON PKWY @ ST LT#4332056E	L 7110
NEWHALL (2009)	1,010.370 307.962	LA CO DPW BM BR DISK MRK'D 7111, @ CTR OF N'LY ABUTMENT COMMERCE CTR DR OVER CASTAIC CRK, 0.2MI N/O HWY 126	L 7111
NEWHALL (2009)	1,058.181 322.535	RCE TAG#9553, S'LY CURB RYE CYN RD @ PROD AVE CROCKER	L 7112
NEWHALL (2009)	1,070.435 326.270	RCE TAG#16913, N'LY CURB RYE CYN RD @ CL PROD BEALE CT	L 7113
NEWHALL (2009)	1,080.726 329.406	RCE TAG#16913, S'WY COR AVE SCOTT & RYE CYN RD (BCR &FH)	L 7114
NEWHALL (2009)	1,397.148 425.852	RCE TAG#9553, NW COR COPPER HILL RD & KATHLEEN AVE, W'LY BCR	L 7115
NEWHALL (2009)	1,436.272 437.777	RCE TAG#95553, SW COR COPPER HILL RD & BENZ RD, 1' S/O BCR	L 7116
NEWHALL (2009)	1,429.307 435.654	L&BRAD, NW COR COPPER HILL DR & N. HIGH RIDGE DR, W'LY TOP 'X' ADA RAMP	L 7117
NEWHALL (2009)	1,276.604 389.110	L&BRAD 1' E/O BCR @ SE COR COPPER HILL DR & CANTERBURY CT	L 7118
NEWHALL (2009)	1,256.152 382.876	LA CO BM BR DISK MRK'D 7119, @ S.END CB, SW COR COPPER HILL DR & MC BEAN PKWY	L 7119
NEWHALL (2009)	1,226.639 373.881	L&BRAD, 3' E/O BCR @ SE COR COPPER HILL DR & TESORO VILLAGE (PRIVATE)	L 7120
NEWHALL (2009)	1,239.036 377.659	L&BRAD, 1'W'LY O/BCR, SW COR COPPER HILL DR & RIO NORTE DR, 4.5' E'LY OF CB	L 7121
NEWHALL (2009)	1,305.661 397.967	L&BRAD, 7' S/O BCR 2 NE COR COPPER HILL DR & WEST HILLS DR (S'LY)	L 7122
NEWHALL (2009)	1,298.820 395.882	LA CO BM BR DISK MRK'D 7123, IN N.END CB OPP S'LY DRWY HSE#24505 COPPER HILL DR	L 7123
NEWHALL (2009)	1,302.548 397.018	L&BRAD, 9' E'LY O/BCR, SE COR COPPER HILL DR & N. COPPERSTONE DR (NEAR W'LY ADA TOP 'X')	L 7124
NEWHALL (2009)	1,280.833 390.399	LS TAG#5000, E'LY BCR S'LY COR COPPER HILL DR & DECORO DR (3' E'LY O/ ST LT#4444621E)	L 7125
NEWHALL (2009)	1,161.211 353.938	L&BRAD, SW'LY COR COPPER HILL DR & SMYTH DR, N'LY END ADA RAMP, (22' S'LY O/CB)	L 7126

QUAD YEAR	ELEV FOOT/METER	DESCRIPTION	BM NUMBER
NEWHALL (2009)	1,121.438 341.815	LA CO BM BR DISK MRK'D 7127, SW COR RYE CYN RD & NEWHALL RANCH RD, @ S'LY BCR (ST LT#4367113E)	L 7127
NEWHALL (2009)	1,461.571 445.488	LA CO BM BR DISK MRK'D 7128, E'LY SIDE SIERRA HWY, 375' N /O FLYING TIGER DR, 2' NE OF S'LY END OF BRIDGE OVER RR (SET ON TOP OF WALL)	L 7128
NEWHALL (2009)	1,738.272 529.827	LACO DPW TAG IN NLY END C.B. IN W CB SIERRA HWY 36' N/O BCR @ NW COR GOLDEN VALLEYRD	L 7129
NEWHALL (2009)	1,456.901 444.065	LACO DPW TAG IN W CB SIERRA HWY 43' W/O C/L & 10' N/O N END DRWY @ HISTORICAL MONUMENT (0.2MI N/O PLACERITA CYN RD)	L 7130
NEWHALL (2009)	1,736.794 529.376	LACO DPW TAG IN W CB SIERRA HWY 2' N/O N END DRWY 43' W/O C/L & 0.2MI S/O GOLDEN VALLEY RD (62' N/O PP #4081379E)	L 7131
NEWHALL (2009)	1,656.041 504.763	CA DIV OF HWYS TAG IN W'LY CURB SIERRA HWY & 0.8MI N/O PLACERITA CYN RD (20' N/O PP#4081388E)	L 7132
NEWHALL (2009)	1,647.222 502.075	LA CO DPW TAG, W. CURB, NW COR PLUM CYN RD & LA MADRID DR	L 7133
NEWHALL (2009)	1,423.902 434.007	LA CO DPW TAG, N. BCR, NE COR PLUM CYN RD & VIA JOYCE DR (S. END OF C.B.)	L 7134
NEWHALL (2009)	1,468.817 447.697	LA CO BM BR DISK MRK'D 7135, NW'LY COR DRWY HSE# 29114 BOUQUET CYN RD	L 7135
NEWHALL (2009)	1,457.753 444.324	LA CO BM BR DISK MRK'D 7136, @ MM 19.08 BOUQUET CYN RD, SW'LY END OF NW HEADWLL	L 7136
NEWHALL (2009)	1,498.926 456.874	LA CO BM BR DISK MRK'D 7137, OPP HSE#29527 BOUQUET CYN RD, 2' SE PP#1527304E (MP 3'SW'LY)	L 7137
NEWHALL (2009)	1,525.548 464.988	LA CO BM BR DISK MRK'D 7138, 55' N/O & 65' W/O CL INT BOUQUET CYN RD & VASQUEZ CYN RD, 3' E/O PP#4729653E	L 7138
NEWHALL (2009)	1,511.490 460.704	LA CO BM BR DISK MRK'D 7139, IN 2" IP FL, 3' W/O GP#4041142E, 21' N/O CL PLACERITA CYN RD, 95' W/O MM 2.77	L 7139
NEWHALL (2009)	1,878.085 572.442	LA CO ENG'R TAG IN W.END ROCK & CONC WALL, 37' W/O MM 5.69 PLACERITA CYN RD (MRK'D DC-1 LA CO 1961)	L 7140
NEWHALL (2009)	1,648.710 502.528	LA CO BM BR DISK MRK'D 7141, NE COR SAND CYN RD & SKY RANCH RD (NW'LY TOP 'X')	L 7141
NEWHALL (2009)	1,609.007 490.427	LA CO BM BR DISK MRK'D 7142, IN E. CURB SAND CYN RD 60' N/O VALLEY RANCH RD	L 7142
NEWHALL (2009)	1,573.398 479.573	LA CO BM BR DISK MRK'D 7143, IN E. CURB SAND CYN RD @ SE COR COMET WAY (N.END C.B.)	L 7143
NEWHALL (2009)	1,607.318 489.912	LA CO DPW BM BR DISK MRK'D 7144, N. END OF CATCH BASIN @ SE COR COC CAMPUS EXIT & SIERRA HWY	L 7144
NEWHALL (2009)	1,633.214 497.805	LA CO DPW BM BR DISK MRK'D 7145, S. END OF CATCH BASIN @ NE COR RYAN LN & SIERRA HWY	L 7145

QUAD YEAR	ELEV FOOT/METER	DESCRIPTION	BM NUMBER
NEWHALL (2009)	1,659.303 505.757	LA CO DPW BM BR DISK MRK'D 7146, N'LY TOP X 'ADA RAMP' @ NW COR FITCH AVE & SIERRA HWY	L 7146
NEWHALL (2009)	1,499.828 457.149	L&BRAD 6' N/O BCR @ SE COR ADON AVE & SIERRA HWY	L 7147
NEWHALL (2009)	1,742.549 531.131	LA CO DPW BM BR DISK MRK'D 7148, 10' S/O BCR @ SW COR VISTA PT LN & SAND CYN RD (LT STD #4497206E)	L 7148
NEWHALL (2009)	1,805.459 550.306	LA CO DPW BM BR DISK MRK'D 7149, E. SIDE SAND CYN RD, HSE #29310, NW'LY COR OF DRWY (LA CO FIRE)	L 7149
NEWHALL (2009)	1,937.213 590.464	LA CO DPW BM BR DISK MRK'D 7150, E. SIDE SAND CYN RD, HSE #29546, 40' S'LY OF DRWY (SW COR EDISON BOX)	L 7150
NEWHALL (2009)	1,862.502 567.692	LA CO DPW BM BR DISK MRK'D 7151 IN W'LY END OF CONC SLAB @GATE TO HSE# 15365 SIERRA HWY	L 7151
NEWHALL (2009)	1,744.477 531.718	LA CO DPW BM BR DISK MRK'D 7152 IN SW'LY END OF NW'LY HEADWALL @MM43.80 SIERRA HWY (0.2MI N'LY OF VASQUEZ RD)	L 7152
NEWHALL (2009)	1,564.721 476.928	LA CO DPW BM BR DISK MRK'D 7153, @SE CPR 6'X7' AT&T PAD, 50' N/O CL VASQUEZ RD & 0.5 MI E/O BOUQUET CYN RD (90' E/O PP#1527329E)	L 7153
NEWHALL (2009)	1,544.378 470.728	LA CO DPW BM BR DISK MRK'D 7154, SET IN 2" IP, 23' N/O CL VASQUEZ RD & 0.25 MI E/O BOUQUET CYN RD (2' S/E PP#1527323E)	L 7154
NEWHALL (2009)	1,765.014 537.978	LA CO DPW BM BR DISK MRK'D 7155, NW'LY COR OF BRIDGE OVER BEE CRK, N/SIDE OF SOLODAD CYN RD	L 7155
NEWHALL (2009)	1,683.287 513.067	LA CO DPW BM BR DISK MRK'D 7156, N/SIDE SOLODAD CYN RD, 140' SW OF HSE# 14045, S'LY COR OF VENT PAD	L 7156
NEWHALL (2009)	1,577.745 480.898	L&T NE COR SOLODAD CYN RD & RUE ENTRÉE, 4' E/O C.B.	L 7157
NEWHALL (2009)	1,590.398 484.755	LA CO DPW BM BR DISK MRK'D 7158, N/SIDE SOLODAD CYN RD, W'LY END OF C.B., 0.25MI E/O SAND CYN RD, 20 E/O LT STD# 4235317E	L 7158
NEWHALL (2009)	1,906.388 581.069	CE MON MRK'D P-1 RE 22728, S'LY SIDE SOLODAD CYN RD, 15'W/O MM 12.74, MKR POST 3' SW'LY	L 7159
NEWHALL (2009)	1,799.392 548.456	LA CO DPW BM BR DISK MRK'D 7160, SET IN 2" IP, S'LY SIDE SOLODAD CYN RD, 95' E/O STONECREST RD, 3.5' S'LY/O PP#844570E	L 7160
NEWHALL (2009)	1,953.358 595.385	LA CO DPW BM BR DISK MRK'D 7161, SET IN 2" IP, S'LY SIDE SOLODAD CYN RD, 165' W/O MM 13.33, 3' S'LY/O PP#2161888E	L 7161
NEWHALL (2009)	1,744.499 531.725	LA CO RDBM TAG, S'LY SIDE SOLODAD CYN RD @MM 11.03, NW COR ROCK & CONC DRN (165' E/O PP#4033639E)	L 7162
NEWHALL (2009)	2,144.977 653.791	LA CO DPW BM BR DISK MRK'D 7163, SET IN 2"IP, 35' N/O CL SIERRA HWY, 0.2MI E/LY HSE#13800(3'N/O PP#4419828E)	L 7163
NEWHALL (2009)	2,205.699 672.299	LA CO DPW BM BR DISK MRK'D 7164, S/SIDE SIERRA HWY @ HSE#13301, N. EDGE CONC SLAB (AT&T BOX)	L 7164

QUAD YEAR	ELEV FOOT/METER	DESCRIPTION	BM NUMBER
NEWHALL (2009)	2,705.640 824.682	LA CO DPW BM BR DISK MRK'D 7165, S/SIDE SIERRA HWY IN W/END HEADWALL, MM#36.47	L 7165
NEWHALL (2009)	2,646.569 806.677	LA CO DPW BM BR DISK MRK'D 7166, E/SIDE AGUA DULCE CYN RD @HSE#34566, NW COR OF GATE RUNNER	L 7166
NEWHALL (2009)	2,837.524 864.880	LA CO BM TAG, 9100 SIERRA HWY, SW COR CONC FOOTER FOR MAILBOX, 80'SSE PP#2366751E	L 7167
BASELINE (2009)	3,038.185 926.042	LA CO DPW TAG, NW COR SOURDOUGH RD & CROWN VALLE RD, 7.5' S/O BCR	L 7168
BASELINE (2009)	3,102.052 945.508	LA CO BM TAG, NE COR SILVERSPUR LN & CROWN VALLEY RD, 9' N/O BCR, NW COR CB	L 7169
NEWHALL (2009)	2,329.136 709.923	LA CO DPW BM BR DISK MRK'D 7170, SET IN 2" IP, 58' NE CL DAVENPORT RD & 200' E'LY OF SUMMIT KNOLL RD (2' NE'LY PP#1337712E)	L 7170
NEWHALL (2009)	2,184.490 665.835	LA CO DPW BM BR DISK MRK'D 7171, SET IN 2" IP, N/SIDE DAVENPORT RD, 55' W/O MM#1.46, 1' SW/O CHAINLINK FENCE POST @W'LY END OF GUARD RAIL	L 7171
NEWHALL (2009)	3,208.335 977.903	LA CO DPW TAG, SE COR CROWN VALLEY RD & BANDELL ST, 5' W/O BCR	L 7172
NEWHALL (2009)	3,171.710 966.740	LA CO BM TAG, 35' S & 20' E/O CL BANDELL ST & WESTSTAR CT, NW COR FIRE HYD SLAB	L 7173
BASELINE (2009)	2,723.102 830.004	LA CO DPW TAG, E CURB CROWN VALLEY RD @ S'LY END OF N'LY DRWY HSE #32248	L 7174
NEWHALL (2009)	3,160.883 963.440	L&BR, 17' W/O NE PROP COR HSE#34458 BRINVILLE RD, S'LY EDGE CONC GUT@S'LY EP	L 7175
NEWHALL (2009)	1,986.953 605.625	LA CO DPW BM BR DISK MRK'D 7176, E/SIDE AGUA DULCE CYN RD, 0.1MI N/O SOLEDAD CYN RD, 8' W/O E/END CONC RET WALL	L 7176
NEWHALL (2009)	2,300.059 701.060	NGS DISC MRK'D AA1304-1977, 23' S/O CL SIERRA HWY & 120' W/O CL EASTERN AVE. UP 3' IN BOULDER (3'MKR POST W'LY)	L 7177
NEWHALL (2009)	2,057.784 627.214	LA CO DPW BM BR DISK MRK'D 7178, 18' W/O CL AGUA DULCE CYN RD, 75' S/O MM#4.86 (OPP 3' TELE BOX)	L 7178
NEWHALL (2009)	1,998.608 609.178	LA CO DPW BM BR DISK MRK'D 7179, N'LY SIDE SOLODAD CYN RD, HSE #10645 (CAMPGROUND), 5' E/O PP#2329939E, SW COR CONC SLAB ELEC BOX	L 7179
NEWHALL (2009)	2,093.849 638.207	LA CO DPW BM BR DISK MRK'D 7180, S'LY SIDE SOLODAD CYN RD, E/END OF S'LY HDWL @ MM#15.70	L 7180
NEWHALL (2009)	2,431.099 741.001	LA CO DPW BM BR DISK MRK'D 7181, 30' N/O SLOLDAD CYN RD, 0.1 MILE W/O MM#19.65, MRK'R POST 1' WEST	L 7181
NEWHALL (2009)	2,500.514 762.159	LA CO DPW BM BR DISK MRK'D 7182, N'LY SIDE SOLODAD CYN RD, HSE#5255 (NEAR PROD OF BOOTLEGGERS CYN RD)	L 7182
NEWHALL (2009)	2,586.753 788.445	L&BRAD CTR HDWL, S'LY SIDE SOLODAD CYN RD, 90' NW'LY SPRR BRIDGE #3784 OVER CROWN VALLEY RD	L 7183

QUAD YEAR	ELEV FOOT/METER	DESCRIPTION	BM NUMBER
NEWHALL (2009)	2,660.332 810.872	LA CO DPW BM BR DISK MRK'D 7184, 50' SE'LY CL INT CROWN VALLEY RD & COUNTRY WAY, SW COR CONC GATE FOOTER	L 7184
NEWHALL (2009)	3,393.442 1,034.324	LA CO ENG'R MON MRK'D 201-79-1961 RE5896, 55'SIERRA HWY, 220' W/O BOILING PT. MTWY (2" M.P. 2' S'LY)	L 7185
NEWHALL (2009)	3,124.601 952.381	LA CO DPW TAG, TOP OF WALL@ SE COR PENMAN RD & SIERRA HWY, NW COR DRAIN	L 7186
NEWHALL (2009)	1,672.281 509.713	CA. DEPT WATER RESOURCES MON, W'LY R/W LAKE HUGHES RD, 35' S/O MM#21.14	L 7187
NEWHALL (2009)	1,375.527 419.262	CA. DEPT WATER RESOURCES MON, SE'LY R/W LAKE HUGHES RD, 105' S/O MM#22.05	L 7188
NEWHALL (2009)	1,280.889 390.416	LA CO DPW BM BR DISK MRK'D 7189, W'LY SIDE OF SAN FRANCISQUITO CYN RD, 20' N/O CL PROP LOWRIDGE PL, SET ON TOP CURB (20' S/O N'LY END OF CURB)	L 7189
NEWHALL (2009)	1,686.813 514.142	1" IP W/DPW TAG DN 4", 25' S'LY CL SAN FRANCISQUITO CYN RD, 7' NW'LY MM#12.70	L 7190
NEWHALL (2009)	1,756.020 535.237	1" IP W/DPW TAG DN 4", SE'LY CL SAN FRANCISQUITO CYN RD, 145' NE'LY MM#12.16	L 7191
NEWHALL (2009)	2,026.364 617.638	LA CO DPW BM BR DISK MRK'D 7192, N'LY SIDE W'LY GATE POST BASE NEAR ROAD 5N17 & DRY GULCH RD (5N30, 0.7 MILE E'LY/O LAKE HUGHES RD)	L 7192
NEWHALL (2009)	1,813.017 552.609	L&BRAD, 3' N/O S'LY END WING WALL ROCK & CONC DRN, 0.7 MILE W'LY/O SAN FRACISQUITO CYN RD (E'LY/O DRWY DRY GULCH RD)	L 7193
NEWHALL (2009)	1,729.845 527.258	LA CO DPW BM BR DISK MRK'D 7194, S'LY SIDE OF N'LY GATE POST BASE @ ROAD 5N30 (DRY GULCH RD) 130' W'LY OF SAN FRANCISQUITO CYN RD	L 7194
NEWHALL (2009)	3,033.024 924.469	LA CO DPW BM BR DISK MRK'D 7195, 45' N/O SIERRA HWY & 0.25 MI E/O RED ROVER MINE RD, IN FH SLAB, 100' W/O DRWY HSE #4609	L 7195
NEWHALL (2009)	3,043.109 927.542	LA CO BM TAG , E/END HDWL, 24' S/O SIERRA HWY, 0.30 MI W/O RED ROVER MINE RD @ MM 29.59	L 7196
NEWHALL (2009)	3,081.641 939.287	USC&GS MON MRK'D 1JRS1983, WARD RD & 14 FRWY, NE COR BRIDGE #B1514	L 7197
NEWHALL (2009)	2,612.952 796.430	LA CO BM TAG, 25' S/O ESCONDIDO CYN RD PROD OF CASA DULCE LN, TOP CONC DRN WALL	L 7198
NEWHALL (2009)	2,494.037 760.185	CO ENG'R MON IN WELL, E/BOUND LANE ESCONDIDO CYN RD PROD ESCODIDO DR, 0.25 MILE E/O AGUA DULCE CYN RD (HSE#10713)	L 7199
NEWHALL (2009)	1,938.851 590.964	LA CO DPW TAG, 200' E/O DRWY HSE#33100 LAKE HUGHES RD, SE COR SCE VAULT	L 7200
NEWHALL (2009)	1,951.881 594.935	L&BRAD TOP OF N'LY HDWL WALL, LAKE HUGHES RD, MM#20.32	L 7201

QUAD YEAR	ELEV FOOT/METER	DESCRIPTION	BM NUMBER
NEWHALL (2009)	1,450.762 442.194	LA CO DPW TAG IN W'LY CURB SIERRA HWY, ¼ MI N/O NEWHALL AVE @ N. END GUARD RAIL	L 7203
NEWHALL (2009)	1,018.506 310.442	LA CO DPW BM TAG, NW COR 'THE OLD ROAD' & HENRY MAYO DR, 1' N/O BCR	L 7204
NEWHALL (2009)	1,000.066 304.821	1" IP W/DPW TAG DN 4", 2' W/O CL PROD COMMERCE CTR DR & 25' S/O HENRY MAYO DR	L 7205
NEWHALL (2009)	961.249 292.990	LA CO DPW TAG, NE COR 3'X10' CONC PAD, 20' S/O S'LY EP HWY 126 & 0.20MI E/O WOLCOTT WAY (50' E/O W.END OF GUARD RAIL)	L 7206
NEWHALL (2009)	1,109.725 338.245	LA CO DPW TAG, SE COR HASLEY CYN RD & COMMERCE CTR DR, 1' E/O BCR	L 7207
NEWHALL (2009)	1,199.838 365.712	L&BRAD, SE COR BOUQUET CYN RD@CL PROD SECO CYN RD	L 7208
NEWHALL (2009)	1,241.289 378.346	L&SPK, NE COR SECO CYN RD & CHAPARRO DR, 7' N/O BCR	L 7209
NEWHALL (2009)	1,388.783 423.302	L&BRAD, SE COR COPPERHILL DR & N. BROOKVIEW TERR., 1.5' W/O BCR (3'W/O LT STD#4386636E)	L 7210